



**SOCIAL IMPACT
ASSESSMENT REPORT ON
LAND ACQUISITION AT 19TH
MILE, BYRNIHAT, RI BHOI
DISTRICT**

**MEGHALAYA INSTITUTE OF GOVERNANCE
SHILLONG**

ABOUT MEGHALAYA INSTITUTE OF GOVERNANCE

The Meghalaya Institute of Governance was created as one of the institutional support mechanism of the Meghalaya Basin Development Authority with a vision to explore, share and promote good governance in Meghalaya by assisting the government, private sector, the voluntary sector, and the communities in putting good governance into practice.

In exercise of powers conferred by the Sub Section (1) of Section 4 of the Right to Fair Compensation and Transparency, Rehabilitation and Resettlement Act, 2013 (No. 30 of 2013), the Government of Meghalaya had notified the Meghalaya Institute of Governance as the State Social Impact Assessment Unit for carrying out Social Impact Assessment Study.

Declaration

This final SIA and SIMP report is purely based on the information given by stakeholders and local people of the villages of 19th Mile, Pahammawlein village, Ri Bhoi District, Meghalaya. Maps and project details were provided by the Office of the Deputy Commissioner, Ri Bhoi District (Revenue), Nongpoh.

This Social Impact Assessment and Social Impact Management Plan is the final SIA report after the Public Hearing.

Officer on Special Duty,
Meghalaya Institute of Governance,
Shillong.

Publication Year - June, 2017



Meghalaya Institute of Governance
Lumpyngad Cottage, Bishop Cotton Road, Shillong- 793001
Phone No.: 0364-2505977, Email: migshillong@gmail.com

Contents

List of Tables	v
List of Figures	v
Abbreviations.....	vi
Executive Summary.....	1
Introduction	3
Objective of the project:	4
Need of the project:.....	4
Project location:.....	5
Maps and Illustration:	6
Research Methodology	8
Methods for Data collection	8
Primary Data	8
Secondary Data	9
Public Hearing	9
Data Processing and Analysis	9
Stakeholder Consultation	10
Description of the Project Area.....	10
Demographic profile of the village:.....	10
Assessment of Land	11
Consultation with Stakeholders:.....	12
Focus Group Discussion with community members of 19th mile.	14
Data Collected From the Public Hearing Held on 10 th June, 2017 at 19 th Mile, Ri Bhoi District, Meghalaya	17
Major Findings	20
Environmental impacts	20
Trees & Vegetation	20
Water Sources.....	20
Impact on Women	20
Impact on Transport and Communication	20
Impacts on Safety.....	21
Impacts on Sanitation & Cleanliness	21
Others	21

Social Impact Mitigation Plan	22
Measures to Avoid, Mitigate and Compensate Impact.....	24
Resettlement Measures	24
Rehabilitation Measures	24
Bibliography.....	26
Annexure 1. Notification to conduct SIA on proposed land acquisition at 19 th Mile Byrnihat.....	27
Annexure 2. Notification for Public Hearing to be Held at 19 th Mile on 10 th June, 2017	28
Annexure 3. Attendance Sheet from the Reconnaissance Survey	29
Annexure 4. Attendance Sheet from the Focus Group Discussion	30
Annexure 5. Attendance Sheet from Public Hearing held on 10 th June, 2017	31

List of Tables

Table 1 Dates of Stakeholder Consultation	11
Table 2 Summary of Consultation with Stakeholders	15
Table 3 Summary Table of Positive and Negative Impacts.....	22

List of Figures

Figure 1 Project Site	4
Figure 2 Map of Land Proposed to be acquired at 19th Mile, Ri Bhoi.....	6
Figure 3 Consultation with Land Owner and former Land Owners on 29th May, 2017	10
Figure 4 KII with member of the Village Durbar.....	12
Figure 5 FGD with village residents on the 5th June, 2017	13
Figure 6 KII with Adjacent Land Owner Shri. B. Mawa on 5th June, 2017	14
Figure 7 Public Hearing at 19th Mile, Ri Bhoi District on 10th June, 2017	17
Figure 8 Public Hearing at 19th Mile, Ri Bhoi District on 10th June, 2017	18
Figure 9 Public Hearing at 19th Mile, Ri Bhoi District on 10th June, 2017	19

Abbreviations

FGD	-	Focus Group Discussion
KII	-	Key Informant Interview
MIG	-	Meghalaya Institute of Governance
SIA	-	Social Impact Assessment
SIMP	-	Social Impact Mitigation Plan
KHADC	-	Khasi Hills Autonomous District Council

Executive Summary

The Meghalaya Institute of Governance, the Social Impact Assessment Unit of the state was assigned the task of conducting a SIA study on the proposed land acquisition for the construction of an Integrated Facilitation Centre – Entry Point at 19th Mile, Byrnihat, Ri Bhoi District, Meghalaya. The proposed land to be acquired measures about 15 acres approximately. This land belongs to an individual Shri. M. L. Shira. This land was identified by the District Administration, Ri Bhoi District for the project.

Following which, the MIG started the SIA study, adopting research methods such as reconnaissance survey, a KII and FGD. The secondary data was supported by the maps and project description received from the Office of the Deputy Commissioner (Revenue), Ri Bhoi District, Meghalaya.

The land to be acquired is a steep hillock. From the site survey and the interactions with the various stakeholders it was learnt that the land was purchased by the present land owner from previous land owners a few years back. These former land owners used to cultivate broom stick on the land. However, as the land had been purchased the land owners have stopped cultivation, yet, the broom stick plant still grows on the land. As was, relayed to the Social Impact Assessment Unit, by an adjacent land owner, the broomstick is free to be collected by them and adds to a part of their annual income.

The residents of the village were hopeful that the project will bring about employment opportunities to the village residents. They also said that the project will increase the safety in the village due to the presence of more police force.

A Public Hearing was conducted on the 10th June 2017 at 19 Mile. During the Public Hearing residents of the village, the land owner, officials from the Office of the Deputy Commissioner, Ri Bhoi District and from the Soil and Water Conservation Department were present. Also present were representatives from different NGOs. At the Public Hearing the project was accepted by the residents of the village.

The SIMP presented here discusses certain safeguards for the project such as proper construction etiquettes as well as safeguards to protect against further landslides, especially in a seismic sensitive area. There is no need to resettle any individual or household. Nor is there any need to compensate for structures as there are none present in the land. There is however, a need to compensate for trees and vegetation that will be lost once the construction of the project occurs.

Introduction

As per The Right to Fair Compensation and Transparency in Land Acquisition, Rehabilitation and Resettlement Act, 2013 the Meghalaya Institute of Governance was assigned the task of conducting a Social Impact Assessment Survey on the land acquisition for the purpose of setting up an Entry Point at 19th Mile, Pahammawlein, Ri Bhoi District Meghalaya¹. The objective of the study is to identify likely impacts which may result from the proposed project.

The concept of an Integrated Facilitation Centre – Entry and Exit Point came up as a concession to the demands of local pressure groups to set up the Inner Line Permit² and thus check on the entry of unwanted elements into the state. The Integrated Facilitation Centre – Entry and Exit Point was proposed to be set up in all sensitive areas of the state to address the issues of influx in the state³ and illegal immigration⁴ into the state. The Integrated Facilitation Centre - Entry and Exit Point proposed by the Government of Meghalaya aims to address these issues. The Integrated Facilitation Centre – Entry and Exit Point proposed to be set up in Ri Bhoi District has been sited at 19th Mile, Pahammawlein. The proposed site for setting up the Entry Point measuring an area of 15.2606 acres is located on a hilly terrain.

The objective of this study is to assess the likely impacts on the village and its residents from the setting up such a project in the site. The research team

¹ See Annexure 1

looked at both the positive as well as the negative impacts the Entry Point would bring.

Objective of the project:

The main objective for the proposed Integrated Facilitation Centre at the Entry point is to prevent and check the influx of the illegal entry into the State. It will facilitate the entry of the people from outside the state.

Figure 1 Project Site



Need of the project:

The project is envisioned to address issues of influx into the State. The Facilitation centre will check arrival of outsiders and will act as an information centre for tourism and registration of migrant labourers.

Project location:

The proposed project area is located in 19th Mile, within 1 km from the Existing NHAI toll plaza at Umling. The distance is 25.4 km from Nongpoh which is the District Headquarter. The total area of the proposed project is 15.2606 Acres in which Plot number 1 is 12.1891 Acres and plot number 2 is 3.0715 Acres. The Entry point has been located on a steep hillock ranging from 275-445 meters above sea level.

Maps and Illustration:

Figure 2 Map of Land Proposed to be acquired at 19th Mile, Ri Bhoi

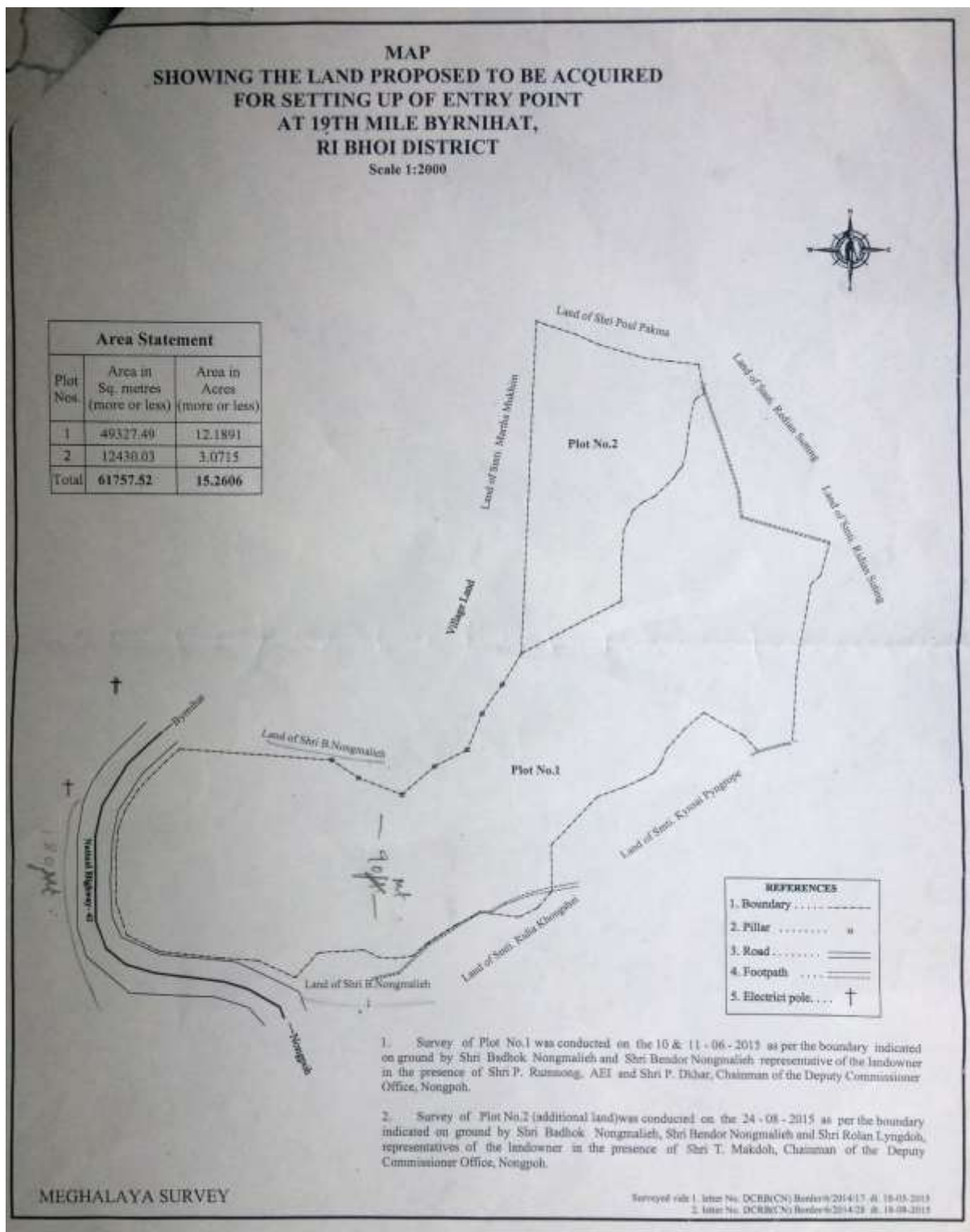

According to the map received from the Revenue Department the project site is bounded by the land of:

- i. Shri. Poul Pakma
- ii. Smti. Redian Suting
- iii. Smti. Kynsai Pyngrope
- iv. Smti. Redia Khongshei
- v. Shri. B. Nongmalieh
- vi. Smti. Martha Mukhim
- vii. Village land
- viii. NH-40

Research Methodology

This Chapter includes the methods and approaches adopted by the Social Impact Assessment Unit to gather information from the field.

The research methodology used is a descriptive one. This method describes the specific behaviour, facts concerning the nature of the problem. It involves gathering data that describes the events, followed by the organisation, tabulation, depiction and description of the data collection.

Methods for Data collection

Primary Data

Primary data was collected through interviews (semi-structured and key informant interview), questionnaire, focus group discussion and field observation.

Reconnaissance Survey

The reconnaissance field survey was carried out to understand the project area and come out with specific Terms of Reference for the project before formulating the questionnaire and interview schedule for primary data collection. Before the data was collected, the research team surveyed the project area, briefed the village functionaries and the respondents about the purpose of the data collection and type of data required.

Key Informant Interview and Focus Group Discussion

The research team took a sample of directly affected respondents and indirectly affected respondents and the functionaries from the Village Executive

Committee using the methods mentioned. The methods used in the field both at the community level and the individual level were structured and designed based on the likely impacts on the project area.

Secondary Data

The research team first reviewed and researched on related literature to understand the requirements and needs of the project area. Based on this literature review, the team was able to get an insight on the background of the project and this allowed for group identification and formulation of questionnaires. The secondary data of relevant documents such as project description, maps, details of land owners, etc. was obtained from the office of the District Commissioner (Revenue Branch), Ri Bhoi District.

Public Hearing

As part of the requirement of the Right to Fair Compensation and Transparency in Land Acquisition, Rehabilitation and Resettlement Act, 2013 a Public Hearing will be held on the 10th June 2017

Data Processing and Analysis

The data collected has been systematically arranged, organised and tabulated by the Social Impact Assessment Team.

Stakeholder Consultation

Description of the Project Area

The project site allocated for setting up of entry point is located in 19th Mile, Pahammawlein which falls under Umling Community and Rural Development Block in Ri Bhoi District. The distance from Umling toll plaza to 19th Mile is 1 Km and 14.5 km from the district Headquarter that is Nongpoh.

Figure 3 Consultation with Land Owner and former Land Owners on 29th May, 2017



Demographic profile of the village:

Brief about 19th Mile Village:

19th Mile is a small sized village in Ri Bhoi District comprising of not more than 20 Household and a total population of 50 people, in which 30 are female

and 20 are male approximately. The overall literacy rate of the village is 20%. All the resident of 19th mile is scheduled tribe. The main occupation of the people is farming and daily labourer.

Table 1 Dates of Stakeholder Consultation

Sl. No.	Type of Consultation	Date of Consultation
1.	Reconnaissance Visit	29 th May, 2017
2.	KII with Village Authority	29 th May, 2017
3.	KII with Land Owners	29 th May, 2017
4.	FGD with former land owners	29 th May 2017
5.	FGD with village residents	5 th June, 2017
6.	KII with Adjacent Land Owners	5 th June, 2017
7.	Public Hearing and Public Consultation	10 th June, 2017

Assessment of Land

Type of land: The land to be acquired is a steep hillock ranging from 275-445 meters above sea level.

Use of Land: According to the Assistant Headman, two households used to cultivate broom sticks before the land was sold to Shri. Mac Shira. Since he bought the land 3 years back it was left barren with no cultivation going on.

Structures on Land: The land which will be acquired has no structures.

Vegetation on Land: The land to be acquired has broomsticks and shrubs which have been planted by the old land owners but since the land has been sold to

the new land owner it has been left unused. The adjacent land owner still goes and collects the broomsticks until now.

Figure 4 KII with member of the Village Durbar



Consultation with Stakeholders:

This section will discuss, interpret and analyse the data collected from the respondents based on Key Informant interview with the land owner and adjacent land owner.

Socio Economic profile of the land owner:

Shri Mac Lyngdoh Shira, owner of the land is a business man residing in Shillong. He bought the land 3 years back from Felicia mary Kharhunai. He also has other properties in different parts of the State. The acquisition of this land will not result in loss but in fact it would bring him financial gain as well as development in that Village.

Figure 5 FGD with village residents on the 5th June, 2017



According to the discussion with the land owner, Shri. Mac Shira, the land has remained unused since he bought the land in 2014. He also mentioned that since the land has remained unused and the no cultivation is going on it will not affect his economic security rather it will improve it.

Socio Economic profile of the adjacent land owner:

Shri Bim Mawa is one of the adjacent land owner from 20th mile, Pahammawlein. He has two children of 6 and 4 years. He earns his income as a daily labourer as well as cultivating broomsticks on his own land. His annual income is around 45,000 to 50,000 Rupees annually.

Shri Bim Mawa an adjoining land owner a resident of 20th Mile said that he cultivate broomstick on his own land adjacent to the proposed project site, he also mentioned that he still collects broomstick from the proposed land which

adds to his annual income. According to him he expressed that it will be a loss for him as he gets extra income ranging from 5000 to 10000 annually by collecting broomsticks from the proposed land.

Figure 6 KII with Adjacent Land Owner Shri. B. Mawa on 5th June, 2017



Focus Group Discussion with community members of 19th mile.

This section will discuss the focus group discussion that is held on the 5th June 2017 with the community members from 19th mile. The number of participants attending the focus group discussion was 10 out of which 9 are male and 1 female. The focus group discussion lasted about an hour and data collected from the discussion has been recorded for future reference.

At the onset a brief introduction was made on the objectives of the social impact assessment study and the institute carrying out the study. Thereafter, the following were the discussion during the focus group discussion

Table 2 Summary of Consultation with Stakeholders

Sl. No.		Remarks by FGD Participants
1.	<i>Awareness level on the proposed project</i>	Participants who attended the Focus group discussion stated that they were aware about the setting up of the facilitation centre cum Entry point in the village from the members of the village authority.
2.	<i>Type of land utility for proposed construction site</i>	The proposed land to be acquired was utilised by the local people for cultivation of broomstick but after Shri. Mac Shira bought the land three years back it has been left unused.
3.	<i>Anticipated Impacts from the project</i>	According to the community members that were present during the discussion they said that the project will have no impact rather it will bring development to the village and will create employment opportunity to the locals. They also mention that there will be no environmental impact as it is a barren land with no cultivation taking place.

4.	<i>Community Safety</i>	When asked about the community safety, the participants said that after the coming of this project it will bring more security as there will be more streetlights as well as police in and around the area which will decrease illegal activities in the village.
5.	<i>Impact on Economic Activity and Income</i>	They were also asked whether the project will have any impact on the Economic activity in the village and surrounding areas; the response was, it will not affect the economic activity instead both men and women will get benefit as they will get to open stalls in or around the project area.
6.	<i>Impacts during the Construction Period</i>	Concerns likely to come up from the construction of the project: Since the people mentioned that there will be no impact from the coming of this project the only concern they have is during excavation of the land soil should be properly dumped.
7.	<i>Expectation from the Project</i>	Expectation from the upcoming project: when the participants were asked about the aspiration from the proposed project, the participants said that first priority in term of job opportunity should be given to the locals.

Data Collected From the Public Hearing Held on 10th June, 2017 at 19th Mile, Ri Bhoi District, Meghalaya

The Meghalaya Institute of Governance conducted a Public hearing on the 10th June 2017 in 19th Mile village Pahammawlein for the construction of Integrated Facilitation Centre cum Entry point which is a part of the Social Impact Assessment Study under the Right to Fair Compensation and Transparency in Land Acquisition, Rehabilitation and Resettlement Act, 2013.

The Hearing was chaired by Shri Aiban Swer O.S.D Meghalaya Institute of Governance in the presence of Smt Y.R Mawlong EAC, MCS from the office of the Deputy commissioner, Ri-Bhoi District, Shri. Y.H.Lyngdoh, Ranger Officer from Soil and water conservation Department and Shri. Bendar Rane, Assistant Headman 19th mile. The hearing was attended by 67 participants out of which 51 were males and 16 were females including few members from the FKJGP Ri-Bhoi Circle.

Figure 7 Public Hearing at 19th Mile, Ri Bhoi District on 10th June, 2017



Shri Aiban Swer commence the hearing by giving a brief introduction about the need for social impact Assessment Study and hence the Public Hearing is being conducted for further clarification on the said acquisition followed by review of the report by Naphisha Kharkongor and Spainlang Lyngdoh from the SIA team.

Shri J. Syngkli, the former headman mentioned that he is happy for the coming of this project as it will check on the influx of the state. He also asks for the opinion from the other participants present there by raising their hands if they disagreed for the coming of this project, none of the hands were lifted which shows that everyone agreed to the setting up of the Integrated facilitation centre cum Entry Point in 19th mile.

Figure 8 Public Hearing at 19th Mile, Ri Bhoi District on 10th June, 2017



Smt Y.R Mawlong EAC, MCS from the office of the Deputy Commissioner, Ri-Bhoi District, said that she is very glad to see the cooperation between the village and the Government in setting up of the project.

Figure 9 Public Hearing at 19th Mile, Ri Bhoi District on 10th June, 2017



The Public Hearing was concluded by Shri Aiban Swer asking all the participants to vote by raising their hands to show the approval to the proposed land acquisition for setting up of the project. All of the participants raised their hand showing they approved to the coming of this project.

Major Findings

This chapter lists the major findings the research team gathered from site visits as well as interaction with the stakeholders

Environmental impacts

The proposed land comprises of a steep hillock which would require a huge amount of earthwork to bring it to road level.

Trees & Vegetation

Even though the land has remained unused for few years but people from the village still collect broomsticks and still get around 5000-10000 per year.

Water Sources

There is a water tank which is just half a kilometre from the proposed land. According to the people from the village, The PHE water tank was handed over to the community but has remained unused for more than a decade since the village has sufficient water sources.

Impact on Women

There will be no impact on women instead it will bring more benefit after the coming of the project as it will give more employment opportunity by opening shops in or nearby the project area.

Impact on Transport and Communication

Transport and communication will be impacted during the construction period as the hill has to be cut down to bring it to road level and since the proposed land is adjacent to the NH40 It would hinder the movement of vehicles.

Impacts on Safety

There will be no impacts instead the project will bring more security as there will be police security in the area and there will be more streetlights which will be safer and decrease illegal activities in the village.

Impacts on Sanitation & Cleanliness

There may be huge amount of earthwork is required to level the land during the construction phase which may make the village and surrounding areas dirty.

Others

The proposed land has a very narrow connection with the National Highway which would make it difficult for entry and exit of large number of vehicles and since the land is a steep hillock there is high possibility of levelling it which would disturb the environment surrounding it especially in a seismic zone like Meghalaya. And there is also a threat of landslides therefore retaining walls need to be built to protect the adjoining properties.

Social Impact Mitigation Plan

The following is the Social Impact Management Plan for the proposed land acquisition at 19th Mile, Byrnihat, Ri Bhoi District, Meghalaya for the purpose of setting up and Entry Point:

Table 3 Summary Table of Positive and Negative Impacts

	Type of Impact	
	Negative	Positive
Agriculture	<ul style="list-style-type: none"> Loss of agricultural land and products 	Nil
Livelihoods	<ul style="list-style-type: none"> Negligible loss of income for some residents. 	<ul style="list-style-type: none"> Employment opportunities within the project. Employment opportunities to local resident during construction phase. Employment opportunities to women during the operational phase as they may set up shops in and around the project.
Trees	<ul style="list-style-type: none"> Loss of trees (horticultural and otherwise) present in the project site 	Nil
Structure	<ul style="list-style-type: none"> Nil 	<ul style="list-style-type: none"> Nil

Surrounding areas	<ul style="list-style-type: none"> • May impact surrounding land owners/users during construction and post construction phase. 	<ul style="list-style-type: none"> • Modern facilities to be installed such as water supply/electricity may improve their access to it.
Electricity supply	Nil	<ul style="list-style-type: none"> • Electricity supply may improve with the setting up of this institute.
Health	<ul style="list-style-type: none"> • Impacts on health due to dust, noise pollution, etc. especially during construction phase. 	Nil
Road	<ul style="list-style-type: none"> • During construction phase commuters on NH-40 may face some inconvenience. • Post construction phase may increase traffic in the area. 	<ul style="list-style-type: none"> • Nil
Safety	<ul style="list-style-type: none"> • During construction phase landslides may increase. 	<ul style="list-style-type: none"> • Increased policing of the area may increase the feeling of safety for the residents. • The increased number of streetlights etc. may also avert criminal activities/intent.

Miscellaneous	<ul style="list-style-type: none"> • Adequate measures should be placed to address unforeseen negative impacts • Increased threat to the seismic sensitive area⁵ 	Nil
---------------	---	-----

Measures to Avoid, Mitigate and Compensate Impact

Resettlement Measures

- The land to be acquired would not require resettlement of any project affected persons.

Rehabilitation Measures

Social Measures

- If there are any dispute between stakeholders, the village durbars should be equipped to deal with usage or other disputes and be ready to refer them to District Council.
- Ensure participation by all community

Economic Measures

- Giving preference to local labour during the construction phase.
- During the operational and other stages of this project, preference should be given to village labour.

Environmental Measures

- There should be arrangements made to prevent raw material spill over.

⁵ (Nandy and Dasgupta 1991)

- Proper care during the construction period that the possibility of landslides must be avoided during the construction phase. During the construction phase, retaining walls, and other measures must be put in place.
- Compensatory afforestation should be made to replace loss of trees.

Bibliography

Nandy, D R, and Sujit Dasgupta. 1991. "Seismotectonic domains of northern India and adjacent domains." *Physics and Chemistry of the Earth* 18 (1).

Annexure 1. Notification to conduct SIA on proposed land acquisition at 19th Mile Byrnihat.

NOTIFICATION
Under Section 4 (2) of RFCT Act, 2013.

Under Section 4 (2) of Right to Fair Compensation & Transparency in Land Acquisition, Rehabilitation and Resettlement Act, 2013.

NO.RDA.106/2015/91

Dated Shillong, the 10th May, 2017

WHEREAS, acquisition of land area measuring 61757.52 Sq.m at 19th Mile, Byrnihat for the purpose of setting up of Facilitation Centre at the Entry Point at 19th Mile, (proposed project) to be constructed/developed by Government of Meghalaya is/are proposed.

WHEREAS, a social Impact Assessment team of the Meghalaya Institute of Governance (MIG) has been formed to consult, to survey and to take public hearing after publication of this Notification.

WHEREAS, the aforesaid team will fix and indicate the dates and venue for which all concerned will be requested to remain present with their claims/objections/suggestions, if any.

WHEREAS, the concerned land owner Shri. Mac Lyngdoh Shira himself or his representative the Headman of 19th Mile, Byrnihat and the villagers may remain present for hearing for consent/approval for the project.

WHEREAS, the process must be completed and SIA report must be submitted along with the plan (SIMP) within the time specified as per RFCT-LARR Act, 2013.

WHEREAS, any attempt at coercion or threat against the process during the specified period will render the exercise null & void.

Now, therefore, if there is any requirement for information, anyone may contact the SIA Unit.



(Shri. B. Hajong, MCS)
Joint Secretary to the Govt. of Meghalaya
Revenue & Disaster Management Department



Meghalaya Institute of Governance

Lumpynggad Cottage, Bishop Cotton Road
Shillong- 793001, Meghalaya

Phone no: 0364- 2505977

No: MIG 193/2016-17/ 633

Email: migshillong@gmail.com

Dated Shillong the, 1st June, 2017

Public Notice

The Meghalaya Institute of Governance has been notified as the State Social Impact Assessment (SIA) Unit to conduct Social Impact Assessment Study for acquisition of land measuring an area of approximately 61757.67 Sq. metres for the purpose of setting up of Integrated Facilitation Centre-Entry Point at 19th Mile, Byrnihat, Ri Bhoi District.

In connection with this, a Public Hearing will be held at Pahammawleifn, 19th Mile, Byrnihat, Ri Bhoi District at 11:00 am on the 10th of June, 2017 (Saturday).

All interested persons are invited to attend the said Public Hearing to express their claims/ objections/ suggestion, if any, on the proposal.

Dr. BDR Tiwari, IAS
Executive Director,
Meghalaya Institute of Governance,
Shillong.

Annexure 3. Attendance Sheet from the Reconnaissance Survey

Attendance Sheet
Social Impact Assessment for Land Acquisition for setting up Facilitation Centre- Entry Point
at 19th Mile, Ri Bhoi District.

Date: 29 May 2017

Sl.no	Name	Gender	Occupation	Phone No	Signature
1	HAC LYNDON SHERA (LAND OWNER)	MALE	BUSINESS	9966024338	
2	FELICIA M. KHARONAI	FEMALE	BUSINESS	9856948092	
3	KWINJINUS JYRNA.	MALE	9862258422 BUSINESS		
4	SARISA MANLOONG	FEMALE	873 0908028 HOUSE WIFE		
5	BILARIS NONGRUM	FEMALE	9732 86 5340 HOUSE WIFE		
6	ANDREW JUNGGA	MALE	98634 95927 BUSINESS		
7	MAN JYRNA	MALE	94367 59383 BUSINESS		
8	BENDER RANGEE	MALE	9774122136 ASST/HEAD MAN		
9					
10					
11					

Attendance Sheet
Social Impact Assessment for Land Acquisition for setting up Facilitation Centre- Entry Point
at 19th Mile, Ri Bhoi District.

Date: 29 May 2017

Sl.no	Name	Gender	Occupation	Phone No	Signature
	Shri. P. Dickan Ri Bhoi. (Rm Inf Br)	M	Govt. Employee	9856818056	
	Shri. T. Maledal. — do —	M.	Govt. Employee	7421985127	

Annexure 4. Attendance Sheet from the Focus Group Discussion held on 5th June, 2017

Attendance Sheet
Social Impact Assessment for Land Acquisition for setting up Facilitation Centre- Entry Point
at 19th Mile, Ri Bhoi District.

Date: 5th June/2017.

Sl.no	Name	Gender	Occupation	Phone No	Signature
1.	Prince Sytkang	M		9774774772.	[Signature]
2.	Bender Rane	M		9774122136	[Signature]
3.	Hering star Suling	M		9774308006	[Signature]
4.	Wat Syng Ali	M		97761668008	[Signature]
5.	Mi Dang	M			[Signature]
6.	Bim Mawa	M			[Signature]
7.	Koring Lungsok	M		9779567800	[Signature]
8.	Senila P. Sytkang	F.			[Signature]
9.	Arbor Khar Syntees			9862201384.	[Signature]
10.	Koming F.				

Annexure 5. Attendance Sheet from Public Hearing held on 10th June, 2017

Attendance Sheet (Public Hearing)
Social Impact Assessment for Land Acquisition for setting up Facilitation Centre- Entry Point
at 19th Mile, Byrnhat, Ri Bhoi District.

Date: 10.06.17

Sl.no	Name	Gender	Occupation	Phone No	Signature
1	Bemdas Ranne	M	Asst. Headman	9774122126	B. Ranne
2	Luislai Lyngdoh	M	Genl. Secretary / k. j. j. j.	9863145850	L. Lyngdoh
3	Mudainy Mlyon	M		9862866522	M. Mlyon
4	P. Phas. Dkhah.	M	LABOUR	82978838	P. Dkhah.
5	Kaminy Lyngdoh	M	LABOUR	972957302	K. Lyngdoh
6	Lana Rani	M	LABOUR	8794475898	L. Rani
7	JOS PAR SYNGKI	M	- do -	9774069723	J. Syngki
8	WAR LYNGDOKH	M	- do -	-	WAR
9	SOCIAL TANGSANG	M	- do -	-	S. Tangsang
10	TRESILIN SYLING	F	- do -	-	T. Syling
11	Balongwahlong	F	HOUSE WIFE	-	B. W

Attendance Sheet (Public Hearing)
Social Impact Assessment for Land Acquisition for setting up Facilitation Centre- Entry Point
at 19th Mile, Byrnhat, Ri Bhoi District.

Date: 10.06.2017

Sl.no	Name	Gender	Occupation	Phone No	Signature
12	WONG SIKHOM KHONG FOK	F	HOUSE WIFE	9862886595	W. Khong Fok
13	Ryan Tangsang	M	BUSINESS	9856658936	R. Tangsang
14	SORIHAN LYNGDOKH	M	- do -	8413003955	S. Lyngdoh
15	Phida Shadap	F	-	-	Phida
16	Balongstone SYIEM	M	BUSINESS	7085884963	B. Syiem
17	Jonathan Syngki	M	- do -	9774647639	J. Syngki
18	Mardaka Syicheng	F	HOUSE WIFE	9131074581	M. Syicheng
19	Risalin Shadap	F	- do -	7085252875	R. Shadap
20	Julia Lyngdoh	F	- do -	8732850935	Julia Lyngdoh
21	LIMLAPBA - MAARAO	M	vice-president PSCAP	5974158052	L. Maarao
22	Shondra Lyngdoh	M.	M.P.	9866813317	S. Lyngdoh

Attendance Sheet (Public Hearing)
Social Impact Assessment for Land Acquisition for setting up Facilitation Centre- Entry Point
at 19th Mile, Byrnihat, RI Bhoi District.

Date: 10.06.2012

Sl.no	Name	Gender	Occupation	Phone No	Signature
23	George Torgony	M	Accountant	8731902718	<i>George</i>
24	A. Lamin	M	-	9612146581	<i>A</i>
25	P. chyma	M	-	8974601756	<i>P</i>
26	Bonica Lyngdoh	F	Teacher	-	<i>Bonica</i>
27	Bilasis Nengom	F	House wife	8732865340	<i>Bilasis</i>
28	Dandashiba Mousin	F		8929844722	<i>D. Mousin</i>
29	Sunita Syliang	F		8730077408	<i>Sunita</i>
30	Nendiz Momi	M	Business	8757767476 85277676	<i>Nendiz</i>
31	Amrasi Syliang	M			<i>Amrasi</i>
32	Arast Sanyal	M			<i>Arast</i>
33	Elvis Syiem	M	Teacher	8257969627	<i>Elvis</i>

Attendance Sheet (Public Hearing)
Social Impact Assessment for Land Acquisition for setting up Facilitation Centre- Entry Point
at 19th Mile, Byrnihat, RI Bhoi District.

Date: 10.06.2012

Sl.no	Name	Gender	Occupation	Phone No	Signature
34	Abdul Ali	M	Farming	7612979782	<i>Abdul Ali</i>
35	Amjun Dylliang	M	''	8413039445	<i>Amjun</i>
36	J. K. Sanyal	M	''	8794006837	<i>J. K.</i>
37	DOT SHRDP	M	''	-	<i>DOT</i>
38	DONMOL Syliang	M	Telgate	8794256680	<i>Donmol</i>
39	Floring Sbr Subig	F	Telgate	9774308008	<i>Floring</i>
40	Jes Sanyal	M	Driver	9774067887	<i>Jes</i>
41	Mat Sanyal	M	Farmlabour		<i>Mat</i>
42	Pearima Syliang	F	House wife	8794255576	<i>Pearima</i>
43	Sit Phosimai Syliang	F	House wife	8794628436	<i>Sit Phosimai</i>
44	Bargi Syliang	M	DRIVER	8267885837	<i>Bargi</i>

Attendance Sheet (Public Hearing)
Social Impact Assessment for Land Acquisition for setting up Facilitation Centre- Entry Point
at 19th Mile, Byrnhat, Ri Bhoi District.

Date: 10.06.2012

Sl.no	Name	Gender	Occupation	Phone No	Signature
45	Bankrupang Shalop	M	Farmer	700062273	B.S
46	Normal Das	M	Driver	7085252231	NIR Malpas
47	Kung wahlang	M	"	9862866468	Kung
48	Dream San Lyngdoh	M	Artist	3256968302	D Lyngdoh
49	Nicholas Lyngdoh	M	Farmer	813016778	N Lyngdoh
50	Dionist Lyngdoh	F	Farmer	7085280637	D Lyngdoh
51	Atahar	F	Housewife	7085778237	Atahar
52	Pimai dhor Lyngdoh	M	Farmer	3256968302	P Lyngdoh
53	Borhal Snyngli	M	- - -	-	B. Snyngli
54	Johari Lyngdoh	M	Farmer	8794315874	J Lyngdoh
55					

Attendance Sheet (Public Hearing)
Social Impact Assessment for Land Acquisition for setting up Facilitation Centre- Entry Point
at 19th Mile, Byrnhat, Ri Bhoi District.

Date: 10.06.2012

Sl.no	Name	Gender	Occupation	Phone No	Signature
46	Shi T. H. Lyngdoh	M	R.O.	9868277425	Shi
47	Shawitpina Bapung	F	Range (owner)	9863028128	Shawitpina
54	Sweetmay Slyta	F	S.C.D (M-F)	9856331842	Sweetmay
59	MAL LYNDOR SASPA	M	Business	9856024338	MAL
60	SANJOY KURBAH	M	"	98625-08998	SANJOY
61	M. JILWA	M	"	9436754383	M. JILWA
62	Kham Mangum	M	Farmer		Kham
63	Bankrupang narokum		Farmer	7658731095	Bankrupang
64	Starlington Lyngdoh				SL
65	Ribon Lang				RS
66	Mufafone	M	Farmer	-	MP

Attendance Sheet (Public Hearing)
Social Impact Assessment for Land Acquisition for setting up Facilitation Centre- Entry Point
at 19th Mile, Byruihat, Ri Bhoi District.

Date: 18.06.2017

Sl.no	Name	Gender	Occupation	Phone No	Signature
67	Mr. Khongpa	M	Farmer	—	P. Khongpa