

# Social Impact Assessment Report on Land Acquisition For The Purpose Of Setting Up An Exit Point At 12<sup>th</sup> Mile, Ri Bhoi District, Meghalaya.



सत्यमेव जयते

**Meghalaya Institute of Governance**

Lumpyngad Cottage, Bishop Cotton Road, Shillong- 793001

Phone No.: 0364-2505977, Email: [migshillong@gmail.com](mailto:migshillong@gmail.com)

## **ABOUT MEGHALAYA INSTITUTE OF GOVERNANCE**

The Meghalaya Institute of Governance was created as one of the institutional support mechanism of the Meghalaya Basin Development Authority with a vision to explore, share and promote good governance in Meghalaya by assisting the government, private sector, the voluntary sector, and the communities in putting good governance into practice.

In exercise of powers conferred by the Sub Section (1) of Section 4 of the Right to Fair Compensation and Transparency, Rehabilitation and Resettlement Act, 2013 (No. 30 of 2013), the Government of Meghalaya had notified the Meghalaya Institute of Governance as the State Social Impact Assessment Unit for carrying out Social Impact Assessment Study.

Publication year: 2017

## Contents

List of Figures .....	4
Abbreviations .....	5
Executive Summary .....	6
Introduction .....	8
Description of Project Site .....	11
Objectives of the project: .....	11
Need for the Project .....	11
Project Location.....	11
Proposed Project Implementation .....	12
Research Methodology.....	14
Research Method .....	14
Methods for Data collection .....	14
Primary Data .....	14
Reconnaissance Survey .....	14
Focus Group Discussion (FGD).....	14
Interviews.....	15
Public Meeting.....	15
Secondary Data .....	15
Public Hearing .....	15
Data Processing and Analysis.....	15
Description of Project Area.....	16
Demographic Profile of Village.....	16
Description of Project Area.....	16
Anticipated Project Impacts.....	17
Data Interpretation .....	19
Socio Economic Profile of the Respondents .....	19
Disputes, if any .....	21
Topography of Land.....	22
Land Use.....	23
Structures on the Land .....	23

Income from Land .....	24
Dependents on Land.....	24
Respondents' Opinion on the Project.....	25
Public Meeting - 17 <sup>th</sup> December 2016.....	27
Data Collection from the Public Hearing held in Umpher Village.....	31
Addendum .....	37
Summary of Findings .....	39
Social Impact Mitigation Plan .....	42
References .....	43
Annexure 1 Letter From DC Office, Ri Bhoi District .....	44
Annexure 2 Letter from Shri Mac Lyngdoh Shira.....	45
Annexure 3 No Objection Certificate from KHADC.....	46
Annexure 4 Public Notice for the Conduct of a Public Hearing on 30 <sup>th</sup> January, 2017 .....	47
Annexure 5 Meeting on 25 <sup>th</sup> August 2016.....	48
Annexure 6 Attendance During Focus Group Discussion on 15 <sup>th</sup> September, 2019.....	49
Annexure 7 Attendance Sheet from Public Consultation held on 17 <sup>th</sup> December, 2016.....	50
Annexure 8 Attendance at Public Hearing held on 30 <sup>th</sup> January, 2017.....	54
Annexure 9 Opposition to the Exit Point.....	59
Annexure 10 Letter From Matchokgre Village Durbar in Support of Setting up Exit Point at 12 <sup>th</sup> .....	60
Annexure 11 Land Deed of Shri Victor Rani.....	62
Annexure 12 No-Objection Certificate from Umpher Village to Shri. Victor Ranees .....	65
Annexure 13 Letter in Support of Proposed Exit Point at 12 <sup>th</sup> Mile.....	66



## List of Figures

Figure 1 Map of Meghalaya .....	9
Figure 2 Map of Ri Bhoi District .....	10
Figure 3 Project Site at Umpher Village.....	11
Figure 4 Map of Proposed Site.....	13
Figure 5 Area adjacent to project site .....	16
Figure 6 Proximity of structures to project site .....	17
Figure 7 Area adjacent to project site .....	18
Figure 8 Focus Group Discussion with Umpher Residents .....	19
Figure 9 Interview with Shri. Francis Marak .....	20
Figure 10 Interview with Smt. Rashila G. Momin.....	20
Figure 11 Key Informant Interview with Smt. B. Rani .....	21
Figure 12 Project Site.....	22
Figure 13 Rented House on Smt. B Rani's property .....	23
Figure 14 Structures on Smt. Rashila Momin's land.....	23
Figure 15 Shops present at Project Site.....	24
Figure 16 Public Meeting Held at Umpher Village on 17.12.16.....	27
Figure 17 Public Meeting Held at Umpher Village on 17.12.16.....	28
Figure 18 Public Meeting Held at Umpher Village On 17.12.16 .....	29
Figure 19 Public Hearing at Umpher Village on 30.01.17 .....	31
Figure 20 Shri Hilter Sangma, Headman Umpher Village at Public Hearing on 30.01.17.....	32
Figure 21 Public Hearing 30.01.17.....	32
Figure 22 Public Hearing 30.1.17 .....	33
Figure 23 Public Hearing 30.1.17 .....	33
Figure 24 Public Hearing 30.1.17 .....	33
Figure 25 Public Hearing 30.01.17.....	34
Figure 26 Public Hearing 30.1.17 .....	34
Figure 27 Public Hearing 30.01.17.....	34
Figure 28 Public Hearing 30.01.17.....	35
Figure 29 Public Hearing 30.01.17.....	35
Figure 30 Public Hearing 30.01.17.....	35

## Abbreviations

ILP	-	Inner Line Permit
KHADC	-	Khasi Hills Autonomous District Council
MIG	-	Meghalaya Institute of Governance
NH	-	National Highway
RFCTLARR	-	Right to Fair Compensation and Transparency in Land Acquisition, Resettlement, and Rehabilitation
SIA	-	Social Impact Assessment

## Executive Summary

---

Umpher is a village on the side of NH-40. It is about 4kms from the entry point into Meghalaya from Assam at Khanapara and 75 kms away from the Meghalaya's capital, Shillong. The Government of Meghalaya's proposal to set up Integrated Facilitation Centre- Entry and Exit Point came as a concession to the demands of local pressure groups to install the Inner Line Permit (ILP) to check on the entry of illegal immigration into the state. For this Integrated Facilitation Centre-Entry and Exit Point to be set up in Byrnihat District of Meghalaya, the Entry Point is proposed to be set up in 19<sup>th</sup> Mile, Pahammawlein and the Exit Point in 12<sup>th</sup> Mile, Umpher. The two sites are 10kms apart and the exit point is at the border of Assam with NH-40 acting as the border between the two states.

The amount of land that is proposed to be acquired is 2.0431 acres. The plot of land was selected by the District Administration for the said purpose. The site belongs to Shri. Mac Lyngdoh Shira. The project site is part of a hillock in Umpher village. The village has a mixed community of Garos and Khasi and others, the Garo community are the majority group.

The Meghalaya Institute of Governance (MIG) had carried out a Social Impact Assessment (SIA) study on the proposed land acquisition for the purpose of setting up of an Integrated Facilitation Centre – Exit Point at 12th Mile, Umpher, Byrnihat, Ri Bhoi District. The objective of this study was to identify the likely impacts which may result from the proposed land acquisition and the subsequent setting up of the Exit Point.

The research methods adopted for this study were quantitative as well as qualitative wherein primary data was collected from the respondents using tools such as reconnaissance survey, interviews, focus group discussions as well as public meeting and public consultations.

The setting up of the Exit Point in the village met some impediments along the way such as issues of land ownership. Moreover, the setting up of an Exit Point created much dissonance in the community with local groups coming out to oppose the setting up of the Exit Point in the village<sup>1</sup>. During the Public Consultation with the community, it was seen that the village community as well as other interested groups were opposed to the project. The reason they listed out for their objections, was that due to the small size of the village the project site would mean the loss of a considerable amount of land for the village as well as concerns over the safety of school children.

From the findings during the focus group discussions, interviews, the public meeting and the public consultation we may conclude that the proposed project would impact the community during the construction phase, on the other hand, employment opportunities would be created. As opined by the community members during the Public Consultation on the 30<sup>th</sup> January, 2017 their fears from the setting up of the Exit Point in their village would mean losing a considerable amount of land. However, the people were not opposed to the entry and exit point but wanted the site for the exit point to be shifted elsewhere. During the construction phase proper safeguards must be put in place keeping in mind the topographical characteristics of the site selected. Also, the distance between the Entry Point and the Exit Point is quite significant. The placement of the Entry and Exit Points closer together would be better suited to the purpose of the project.

---

<sup>1</sup> See Annexure 9

## Introduction

---

As per The Right to Fair Compensation and Transparency in Land Acquisition, Rehabilitation and Resettlement Act, 2013 the Meghalaya Institute of Governance was assigned the task of conducting a Social Impact Assessment Survey on the land acquisition for the purpose of setting up an Exit Point at 12<sup>th</sup> Mile, Umpher, Ri Bhoi District Meghalaya<sup>2</sup>. The objective of the study is to identify likely impacts which may result from the proposed project.

The concept of an Integrated Facilitation Centre – Entry and Exit Point came up as a concession to the demands of local pressure groups to set up the Inner Line Permit<sup>3</sup> and thus check on the entry of unwanted elements into the state. The Integrated Facilitation Centre – Entry and Exit Point was proposed to be set up in all sensitive areas of the state to address the issues of influx in the state<sup>4</sup> and illegal immigration<sup>5</sup> into the state. The Integrated Facilitation Centre - Entry and Exit Point proposed by the Government of Meghalaya aims to address these issues.

The Integrated Facilitation Centre – Entry and Exit Point proposed to be set up in Ri Bhoi District has been sited at 19<sup>th</sup> Mile, Pahammawlein (Entry Point) and 12<sup>th</sup> Mile, Umpher (Exit Point). The distance between these two sites is more than 10 kms.

---

<sup>2</sup> Vide Letter No. RDA.89/2015/21 dated 5<sup>th</sup> February, 2016

<sup>3</sup> “Modified ILP proposal in Meghalaya”, The Telegraph, Calcutta, 30<sup>th</sup> April, 2014, accessed from [http://www.telegraphindia.com/1140430/jsp/northeast/story\\_18292995.jsp](http://www.telegraphindia.com/1140430/jsp/northeast/story_18292995.jsp)

<sup>4</sup> “Setting up of Entry/Exit Points to check influx fast tracked: Meghalaya CM Mukul Sangma”, The Economic Times, 3<sup>rd</sup> August, 2015 accessed from [http://articles.economictimes.indiatimes.com/2015-08-03/news/65165750\\_1\\_meghalaya-cm-mukul-sangma-draft-bill-meghalaya-regulation](http://articles.economictimes.indiatimes.com/2015-08-03/news/65165750_1_meghalaya-cm-mukul-sangma-draft-bill-meghalaya-regulation)

<sup>5</sup> “Meghalaya plans entry/exit points to check illegal immigration”, Business Standard, Shillong, 10<sup>th</sup> July, 2014 accessed from [http://www.business-standard.com/article/pti-stories/meghalaya-plans-entry-exit-points-to-check-illegal-immigration-114071001396\\_1.html](http://www.business-standard.com/article/pti-stories/meghalaya-plans-entry-exit-points-to-check-illegal-immigration-114071001396_1.html)

The objective of this study is to assess the likely impacts the project would have on the village and its residents. The research team looked at both the positive as well as the negative impacts the Exit Point would bring.

Figure 1 Map of Meghalaya

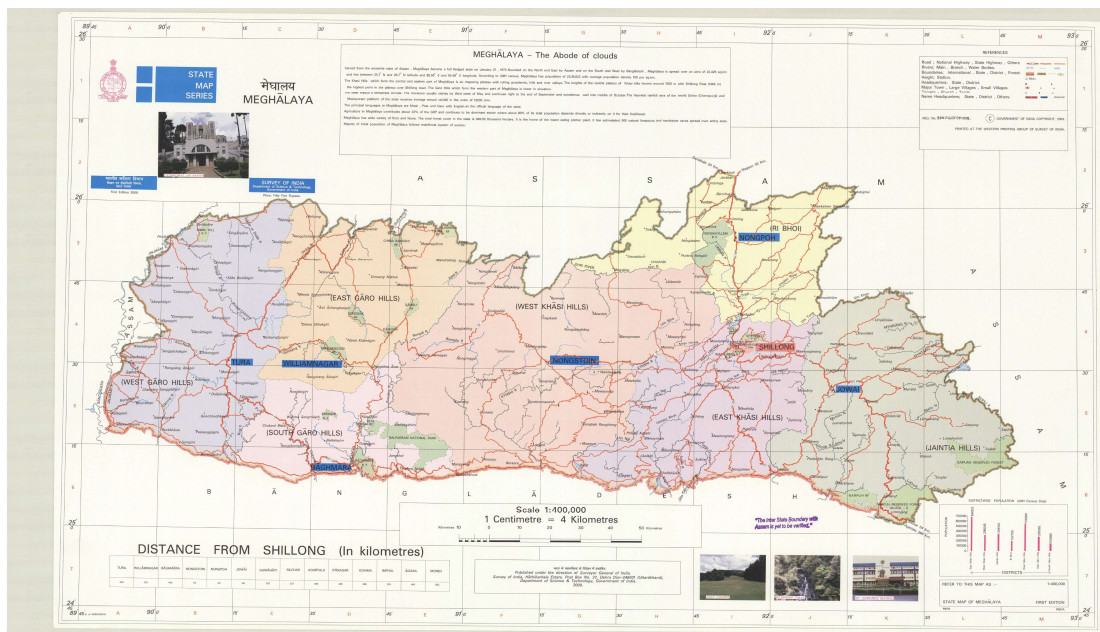

(Source: Survey of India, 2009)

The project is proposed to be set up in Ri Bhoi District of Meghalaya. The population of Ri Bhoi per the 2011 Census is 258, 840. It has an area of 2,448 sq.km with a density of 105.7 /sq.km. Its percentage of literates is 75.67 per cent. Its Scheduled Tribe (ST) population is 88.89 per cent and it has 0.23 per cent of Scheduled Castes (SC) population. It is to be set up in Umling Block which is 599.63 sq.km. It has a total population of 69,966 persons of which 187 persons are Scheduled Castes and 51,239 persons are Scheduled Tribes. A total of 44,115 persons are literates<sup>6</sup>.

<sup>6</sup> District Census Handbook Ri Bhoi, Census of India, Series 18 Part XII-B Accessed from [http://www.censusindia.gov.in/2011census/dchb/1705\\_PART\\_B\\_DCHB\\_RIBHOI.pdf](http://www.censusindia.gov.in/2011census/dchb/1705_PART_B_DCHB_RIBHOI.pdf)

Figure 2 Map of Ri Bhoi District

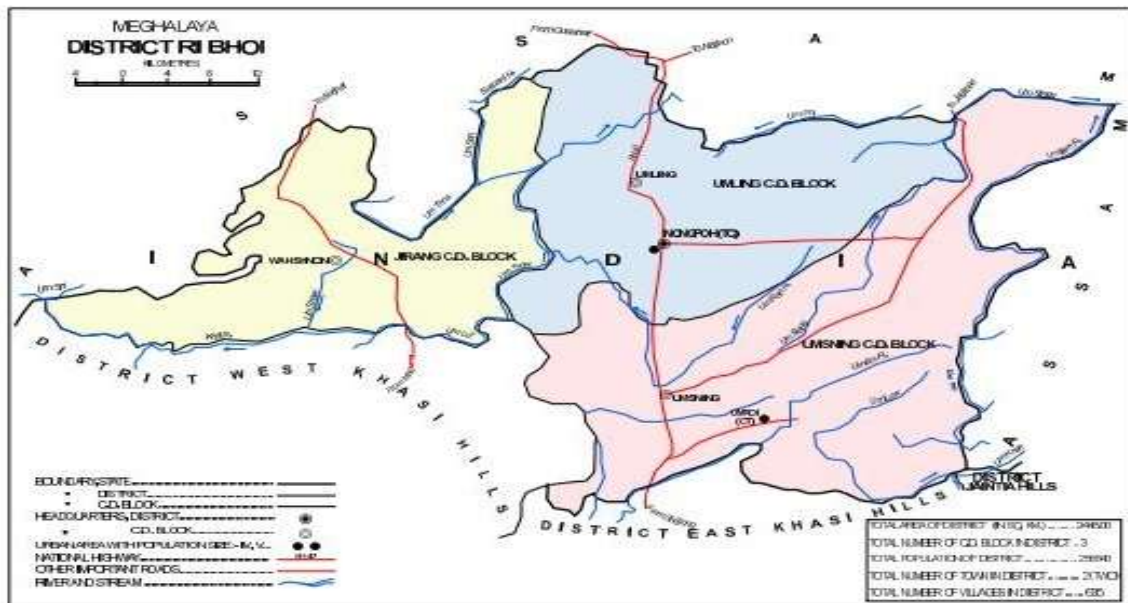

(Source: District Census Ri Bhoi, 2011)

## Description of Project

---

### Objectives of the project:

The objectives of this project are to:

- Check the entry of people into the state
- Provide services to the people living at the state borders which were erstwhile unavailable to them

In this instance, the project site would only facilitate the exit of people from the State.

Figure 3 Project Site at Umpher Village



### Need for the Project

The project is envisioned to address issues of influx into the state. The Integrated Facilitation Centre – Entry and Exit Point will act as a service point to people living at far distances. The Integrated Facilitation Centre – Entry and Exit Point will check all arrivals and departures of people from the state as well as carry out inspection to avoid any kind of unforeseen issues.

### Project Location

The Exit Point has been sited on a hilly terrain at 12<sup>th</sup> Mile, Umpher village, Byrnihat, Umling C&RD Block, Ri Bhoi District of Meghalaya.

The proposed project site is located on a hill terrain. On its left is private property, a village road, St. Jude's' School and the Conservation Training



Institute. It is bounded on all sides by the land of a private individuals and a Petrol Pump. Opposite the proposed site is the Kamrup District of Assam. The proposed site measuring an area of 2.0431 acres is a tract of land which is longer than it is wide. Its boundaries abut with the land of Shri. B.P. Bajoria, Shri Rojen Sangma, Shri. W. Nongmalieh, Smt. Mildret Warjri, Smt. Manju G. Momin, Smt. Nirmala Momin, Smt. Makdalin G. Momin and Smt. Nondita Sangma (from North-to-East-to-South-to-West) as per map provided.

Umpher village has a total of number of 114 households and a population of 509 persons. It has a total ST population of 316 (62%) persons and 441 (86%) persons are literate.<sup>7</sup> The village is besides the NH-40 and on the other side of the road is the state of Assam. A small road from the NH-40 is the approach road into the village.

### Proposed Project Implementation

The project was scheduled to be implemented at the earliest.

---

<sup>7</sup> Census of India, 2011

Figure 4 Map of Proposed Site

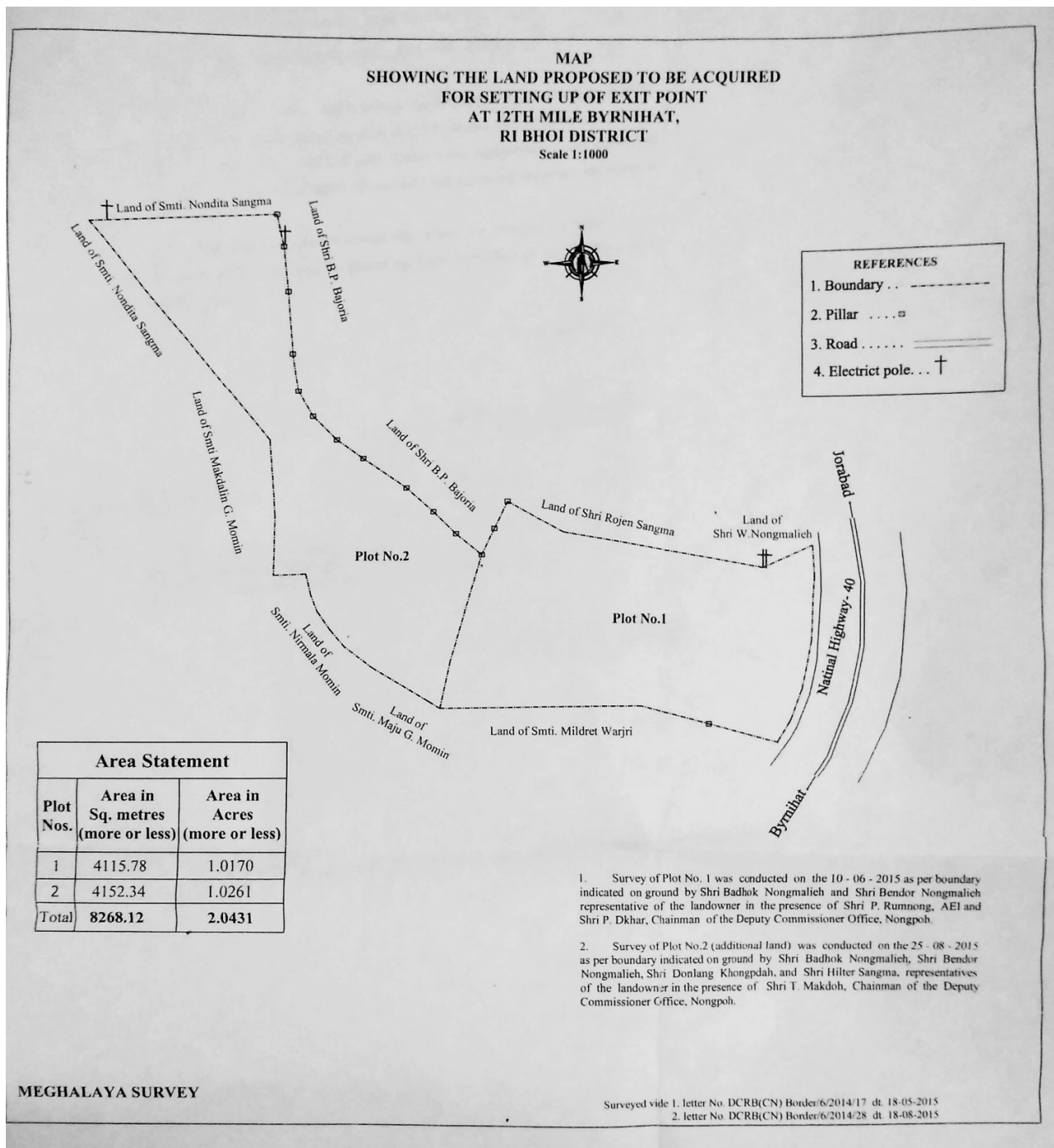

## Research Methodology

---

### Research Method

The research methodology used is a descriptive one. This method describes the specific behaviour, facts concerning the nature of the problem. It involves gathering data that describes the events, followed by the organisation, tabulation, depiction, and description of the data collection.

### Methods for Data collection

The following are the methods that were used for data collection:

#### Primary Data

The research team took a sample of directly and indirectly affected respondents and the functionaries from the Village Executive Committee using the methods mentioned. The target group for respondents were selected on the basis of people's transit between the two states like traders, drivers, farmers, etc. The methods used in the field, both at the community level and the household level, were structured and designed based on the likely impacts on the project area. Primary data was collected through the following ways:

#### Reconnaissance Survey

The reconnaissance field survey was carried out to understand the project area and come out with specific Terms of Reference for the project before formulating the questionnaire and interview schedule for primary data collection. Before the data was collected, the research team surveyed the project area, briefed the village functionaries and the respondents about the purpose of the data collection and type of data required. A primary site visit to assess the nature of the site was completed in August, 2016

#### Focus Group Discussion (FGD)

A focus group discussion with the village headman as well as some community members was completed on 15th September, 2016<sup>8</sup>.

---

<sup>8</sup> See Annexure 6

### Interviews

Key informant interviews (KII) was held on the 25<sup>th</sup> August, and on 15<sup>th</sup> September 2016<sup>9</sup> with different stakeholders such as the land owners, the village headmen, and the occupants of the land.

### Public Meeting

A public meeting was held again on the 17th December, 2016 to settle any further land disputes over the site<sup>10</sup>.

### Secondary Data

The research team first reviewed and researched on related literature to understand the requirements and needs of the project area. Based on this literature review, the team was able to get an insight on the background of the project and this allowed for group identification and formulation of questionnaires. The secondary data of relevant documents such as project description, maps, details of land owners, etc. was obtained from the office of the District Commissioner (Revenue Branch), Ri Bhoi District.

### Public Hearing

As part of the requirement of the Right to Fair Compensation and Transparency in Land Acquisition, Rehabilitation and Resettlement Act, 2013 (Section 5) after the submission of a draft report to governing bodies including the village authority, a public hearing is held at the affected village. The Public Consultation was held on the 30<sup>th</sup> January, 2017.

### Data Processing and Analysis

The data collected has been systematically arranged, organised and tabulated by the Social Impact Assessment Team.

---

<sup>9</sup> See Annexure 6

<sup>10</sup> See Annexure 7

## Description of Project Site

---

### Demographic Profile of Village

The site selected for the construction of the Exit point is situated in the village of Umpher. This village is a medium sized village under the Umling C&RD Block in the Ri Bhoi District of Meghalaya. It has a total of 114 families and a population of 509 people. Of these, 275 are males while 234 are females as per the Population Census 2011. The average sex ration is 851. The village has a high literacy rate at 97.78%. Male literacy stands at 97.52% and female literacy at 98.09%. There are a total of 316 Schedule Tribes in the village which accounts for 62.08%.

### Description of Project Area

The land to be acquired is a hill. It measures about 2.0431 acres. The

Figure 5 Area adjacent to project site



land is private property. It has 1 semi pucca house, 1 pucca house and about 4 kutcha houses. On the side adjoining NH-40, there are 3 thatched roof shops, and 2 brick shops. On its north is the Guwahati-Shillong (GS) Road and opposite this road is the Kamrup District of Assam.

Around the area is located a petrol pump, the village kutcha road, St. Jude's School, the CTI Secondary School and the Conservation Training Institute.

The site has mixed vegetation with some arecanut trees, bamboo clusters, and fruit trees, contribute significant income to the family.

## Anticipated Project Impacts

Figure 6 Proximity of structures to project site

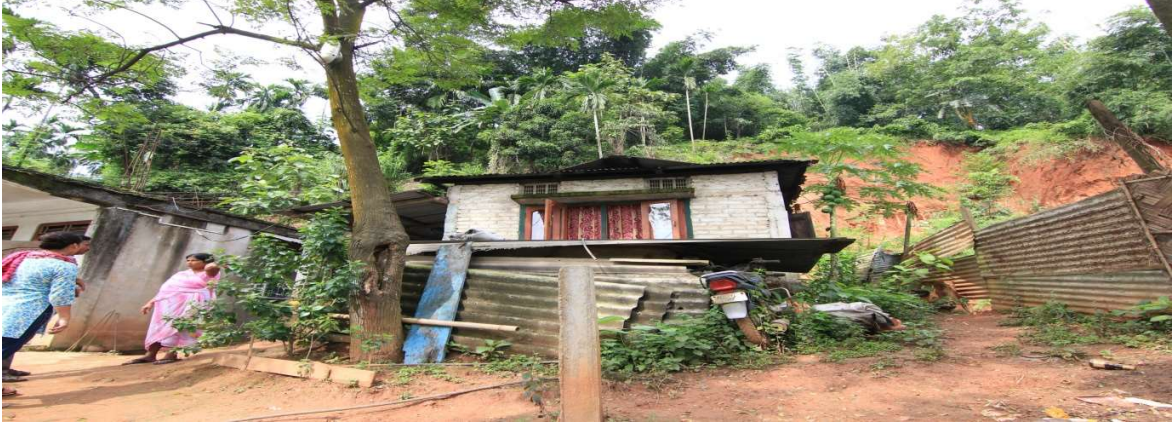

From the reconnaissance survey and an initial interview with the village elders and headman, the following were the SIA teams' observations.

The area is a part of a hill and the setting up on an Exit Point here would require considerable earthwork to level the site and bring it to road level. This would affect all houses and areas around it. The considerable amount of earth that would have to be removed also would mean that a suitable place to dump the earth would be required which is nearby but, so as not to disturb the village and its surrounding areas.

During the construction period, the earthwork would create a lot of hazard to the surrounding houses and the petrol pump adjacent to it. During this time, the drain which runs next to the project site might face a lot of siltation. During this phase, there might be a lot of overflow which would hamper the cleanliness of the village and cause inconvenience to the residents.

During the construction period - the nearby schools, commercial areas, petrol pump, etc. present near the area may face inconvenience during that period. During the construction phase, noise pollution, traffic congestion and safety of the school students is a cause of concern. The saw mills present in the area too may face a fall in production during this period.



The land described as barren land, is not so. It has a few arecanut trees, orange trees, bamboo trees and other vegetation which provides the two families here with some income or at least provides enough products for self-consumption. Apart from this it also has many other plants and trees.

Figure 7 Area adjacent to project site



On the other hand, there may be a rise in income of the small vendors present around. There is great economic potential there. Also, there may be gain to the village residents through employment opportunities

that the project can bring.

The setting up of the Exit Point in the village might bring about a trickledown of development benefits. For example, the kutchra road leading into the village might be metaled. The entry road into the village which sees a lot of flooding because of the improper drainage system on the road might be avoided or reduced.

The petrol pump on the right side of the road too might face some difficulty during the construction period. As will be the electric post located on the project site which might be disturbed during the construction period.

## Data Interpretation

---

The research team had adopted quantitative as well as qualitative research methods. These methods involved Key Informant Interviews as well as Focus Group Discussions. The research team used open ended questionnaires during this process. The following are the findings from the research.

A Focus Group Discussion was conducted with the village headman of Umpher along with a mixed group of 16 residents of the village. Key Informant Interviews with 3 households were conducted. Two of these households live within the project site; and 1 household owns property adjacent to it. A Key Informant Interview with the landowner, Shri. Mac Lyngdoh Shira, was also conducted.

Figure 8 Focus Group Discussion with Umpher Residents



### Socio Economic Profile of the Respondents

Shri. Mac Lyngdoh Shira, owner of the land is a business man residing in Shillong. Shri. Shira bought the land in 2013. Shri. Shira has other properties in different parts of the state. The acquisition of this land for Shri. Shira would not result in loss but in fact would bring him financial gain.



Figure 9 Interview with Shri. Francis Marak



The household of Shri Francis Marak, an indirectly affected family lives about 20 feet away from the project site. The family belongs to the Scheduled Tribe (Garo) community. It is composed of 6 family members; 5 of them are adults above 18 years of age and one is a minor. The only earning member of the family is

Shri. Francis Marak, a government servant earning more than Rs. 10,000 per month with no other source of income.

Smt. Rashila G. Momin an [Figure 10 Interview with Smt. Rashila G. Momin](#)

occupant of the project site has two residential structures in the project site itself. Both are semi-pucca structures. There are 6 family members in her household. Three are adults between the ages of 42-21 yrs and three are minors who are between the ages 16 – 2. Smt. Rashila G. Momin



and her husband Shri. Jengban Ch. Sangma are both daily labourers who earn between Rs. 5,000 to Rs. 7,000 per month. There some arecanut and bamboo trees on the property which are only for self-consumption.

Smt. Bernadette Rani's an occupant of the land, has one pucca house, 3 thatched roof houses, 3 thatched roof shops, 2 pucca shops with shutters and an electric pole at the edge of the property next to the petrol pump. The household belongs to the Scheduled Tribe community (Khasi and Adivasi) comprised of 3

family members, two adults and one minor son. Smt. Bernadette Rani earns rent

Figure 11 Key Informant Interview with Smt. B. Rani



as income from the houses and shops she gives on rent as well as from her small plantation of oranges and arecanut on her property. While her husband Shri. J. Toppo drives an auto rickshaw. Collectively they earn between Rs. 10,000-14,000 per month.

### Disputes, if any

The land on which the project is to be located belongs to Shri. Mac Lyngdoh Shira. According to him in (August, 2016), the land does not fall under any disputed land. This land is owned by Shri. Mac Lyngdoh Shira who had bought the land a few years ago. The land initially was owned by two land owners, of whom some are still occupants of the land who derive part of their income from it.

Prior to the settlement of ownership issues over the project site by the Ri Bhoi District administration the research team had visited the site (September, 2016). At that time, the village headman of Umpher, Shri. Hilter Sangma, revealed that he was not aware of change in ownership of the land. The upper portion of the land or Plot No. 2<sup>11</sup> measuring 1.0170 acres used to belong to Smt. Rashila G. Momin who still resides in the project site as the full payment for the land has not been received. The lower portion of the land or Plot No. 1<sup>12</sup> is occupied by Smt. B. Rane, sister of Shri. V. Rane<sup>13</sup> who was the land owner prior to acquisition through purchase by Shri. Mac Lyngdoh Shira. Smt. Bernadette Rani, on the other hand claimed that the land belonged to her and that she had not sold

---

<sup>11</sup> Vide Survey Map provided by Office of the Deputy Commissioner (Revenue Branch) Ri Bhoi District, Meghalaya.

<sup>12</sup> Ibid

<sup>13</sup> See Annexures 11 and 12 for supporting documents

it to anyone. She said that the land was still in her possession as she had not sold the land to anyone, a claim which she reiterated on the day of the Public Consultation (30.01.17).

The public meeting on 17<sup>th</sup> December 2016 settled all land disputes. During the interaction with Shri. V. Rane, who is also the local MDC, he said that he had inherited the land from his mother on her passing and had sold it off. He also revealed that he would relocate his sister, and her family to another location which would be closer to his residence.

### Topography of Land

The selected project site is on a hillock. On its north is the Guwahati-Shillong Road. Opposite this site is the Kamrup District of Assam. On the Assam side of the road there are a number of small shops. It may be noted that the project site is not comprised of the whole hillock. Cutting the earth to level the hill would

Figure 12 Project Site



require a lot of work. Since only a part of the hill is required the adjoining properties would surely be affected during the construction period. Structures such as houses and shops next to the land would be affected during this period and there is a possibility that they

might be damaged. There is a threat of heavy landslides during the period and retaining walls would need to be built to protect adjoining properties.

## Land Use

According to Shri. Mac Lyngdoh Shira, the land has been un-utilized since he bought it in 2013. No cultivation or plantation has been done in that area.

Smt. Rashila G. Momin has about three arecanut trees and some bamboo trees but their produce are wholly used for self-consumption.



Figure 13 Rented House on Smt. B Rani's property

Smt. Bernadette Rani earns income from the structures she gives on rent. The land also has a small plantation from which she gets oranges and arecanuts. She sells these products annually to earn an additional income.

## Structures on the Land

On Shri. Francis Marak's land there is only one structure, i.e. a residential house.

Figure 14 Structures on Smt. Rashila Momin's land



On Smt. Rashila G. Momin's land there are two semi-pucca structures with tin roofs and cemented floors. One house has brick walls and the other has wooden walls. Both houses have three rooms each.

There is also an electric pole on one side of the property.

There are three pucca structures on Smt. Bernadette Rani's property and six kutcha structures.



### Income from Land

Shri Francis Marak's family earns no income from the land. The family is solely dependent of the father's salaried government job.

Since Shri Mac Lyngdoh Shira has other lands in different places, he said that the acquisition will not affect his economic security rather it will improve it.

Smt. Rashila G. Momin earns no income from the land and uses all products from the land on self-consumption.

This land to Smt. Bernadette Rani is her only source of income. She earns an income of about Rs. 300 per month from the kutcha houses she gives on

Figure 15 Shops present at Project Site



rent. She also earns a small amount of Rs.500-4000 per month for every kutcha and pucca shop she rents out at the base of her property, although when the research team visited the site the pucca shops were unoccupied. Smt. Bernadette Rani too earns an annual income of about Rs. 4,500 from the arecanut and orange trees present on her property.

### Dependents on Land

Although the property of Shri. Francis Marak's falls outside of the project site there is apprehension that the construction will disturb his property especially his residential house. The family has no alternate site to relocate to. If the need for

relocation arises, the family's desired location would be to a site close to the National Highway and prior relocation before their land is acquired.

Although Smt. Rashila Momin has sold her land, her family still lives on it because, as the headman said, Smt. Momin has not received full payment for the land. Also, Smt. Rashila G. Momin's family has no alternate land to shift to but if the need arises for relocation, the family would prefer land or structure in lieu of the loss that will be incurred.

Smt. Bernadette Rani is dependent on this land for her income. Smt. Rani has no alternate land and if land is acquired she will be required to relocate. In the event of relocation then Smt. Rani would like to relocate within the Umpher village itself as her family roots are there.

Apart from her family's dependence on this land there are also three families who are tenants. The first family is that of Shri. Vicky Rani. It is composed of 3 people, one minor and two adults. The head of the household earns his livelihood from driving an auto rickshaw in the area and his wife is a home maker. The second family is that of Shri. Nobiron Ali. It comprises two adults and one minor. The head of the household works as a labourer in a factory located nearby. Smt. Begum Ali's family comprises of two adults and two minor children. Here too, the adults work as labourers in the factory nearby.

Smt. Bernadette Rani also gives employment to 5-6 persons annually to maintain her small plantation. She pays each labourer Rs 300 per day for 2-3 months in a year.

### Respondents' Opinion on the Project

Shri. Mac Lyngdoh Shira is willing to give this land to the government.

Shri Francis Marak is of the opinion that during the construction period, there will be land levelling which will cause a problem to his family as his residence is a mere 20-25 ft away from the project site. There is a fear that the construction will cause soil erosion and consequently destruction of the residential structure.

The family however sees a possibility to set up a shop in there adjacent site which would give them an additional income. The father wants vocational training for his daughters so that they will be economically sufficient.

Smt Rashila G. Momin thinks that the coming of the Exit Point in the area will bring employment opportunities for her and her family.

Smt. Bernadette Rani says that if the project comes through, then she too would desire a job for her husband. If possible, she would like training in a skill she is already familiar with, which is tailoring. Also she sees economic opportunity from the project and hopes to set up a small shop.

From the Focus Group Discussion with the village headman and the residents of Umpher it was learnt that they felt that the setting up of an Exit Point in their village would increase the safety in the village. It would also decrease the influx of people into the state. The project would also provide employment opportunities to the residents of the village. Conversely, some fear that it will threaten their security. However, some other respondents were of the opinion that if there are police present at the site then there will be no difficulties. The participants at the Focus Group Discussion further opined that if the hill is levelled, the adjoining houses will face a lot of difficulty. The construction period will also hinder institutions around it.

## Public Meeting - 17<sup>th</sup> December 2016

---

A public consultation and disclosure for setting up of Exit Point in Umpher Village, 12th Mile, Byrnihat was held on the 17th of December 2016 in the presence of Shri. J. Shylla EAC (Rev.), Ri Bhoi District, Shri ABS Swer OSD, Meghalaya Institute of Governance (MBDA), Shri V. Rani (MDC) along with other stakeholders and community members from the village. The following were the opinions and questions put up by the people present at the meeting.

Figure 16 Public Meeting Held at Umpher Village on 17.12.16



Shri Victor Rani (MDC and landowner) explained the need for construction of the Exit point in the village which will check the influx of people into the state. He stated that the construction will benefit the village by bringing development and employment for the people based on their qualifications. He said that the construction should not be through forced acquisition and that compensation for the land should be made as per the present market rate.

Shri TD Verman (landowner) said that he is willing to give his land for the Exit point if the project is meant for the inclusive growth of the village and its people. Later, he stated that if there are adverse effects to the community he would not be part of such developments.



Shri Joseph Warjri (resident) raised his concerns over the presence of an exit point in the village which would have a direct impact on the school (St. Jude School) nearby the project site. There would be an increase in traffic congestion in the area which would become a disturbance to the school. The project will also affect the roadside vendor. In the long run, he stated, the compensation received by the people will not improve their livelihoods.

Smt. Ardalin Marak (President, Seng Longkmie) along with other residents of the village including Smt Jowakin Bandola, Shri Franseng K Sangma and Smt Anita Lyngwa, said that they understood that the initiative taken by the government would be for the betterment of the people. However, benefits from the project should not be for certain individuals but for the future generations as well. They also said that more time should be given to the people to decide on this project more effectively.

Figure 17 Public Meeting Held at Umpher Village on 17.12.16



Shri Sutendar G Momin (resident) asked about the number of Entry and Exit Points in the state and their effectiveness as well as the need within the state. To this, OSD, MIG replied that the project is still in an infant stage but the EEP shall be constructed in Jaintia Hills, Khasi Hills, and Garo Hills as well.

Shri Challang G Momin (resident) asked what provisions are provided to shopkeepers who stay or have shops around the project site. To which the EAC responded that provisions for shops will be given to the people whose land had been acquired and whose livelihood was solely dependent on that land.

Shri Beril G Momin (resident) asked whether the employment opportunities generated through this project would be permanent or temporary. Also he asked whether there were preventive measures in place to safeguard the adjoining land belonging to other people.

Figure 18 Public Meeting Held at Umpher Village On 17.12.16



After hearing all the opinions and queries of the local people, the EAC present stated that the public consultation was held to create a common environment for collective participation between the state government and the stakeholders. He said that the initiative to set up EEP within the state started due to the demand put up by pressure groups to check influx of people into the state. To address to this, the government has decided on setting up of entry and exit point in the state. In Ri Bhoi District, the Entry point is selected to be set up at 20<sup>th</sup> Mile and for the Exit point the site has been selected in 12th Mile, Umpher village. He said that the project is not only for the village but this is an initiative

for the state as a whole. The process under the new land acquisition Act is lengthy and it would take time for project implementation but he requested the people to not feel insecure about the project as all their grievance will be put forth to the government. He also said that since the project is a time bound project, the state government are speeding up the process. He also assured the people that the process for consultation does not end from one consultation alone rather the people can always approach the DC Office with their queries by writing to him or the DC office.

From the first public consultation and disclosure it was seen that issues of land disputes had been settled. Also, a decision was arrived that a second Public Consultation would be held on the 30th of January, 2017 at 11 a.m. in Umpher community hall to deliberate properly over the same.

## Data Collection from the Public Hearing held in Umpher Village.

---

The Meghalaya Institute of Governance had conducted a public hearing on the 30th January, 2017, on the Integrated Facilitation Centre- Exit point in Umpher village, Ri-Bhoi District at 11:00 a.m., as part of the Social Impact Assessment study under the Right to Fair Compensation and Transparency in Land Acquisition, Rehabilitation and Resettlement Act, 2013 notified by the Ministry of Rural Development, Government of India.

Figure 19 Public Hearing at Umpher Village on 30.01.17



The Public Hearing was chaired by Shri. Aiban Swer, OSD Meghalaya Institute of Governance. Also present were Shri. D. Kharsati (MCS) Additional Deputy Commissioner, Ri-Bhoi District along with the Headman, Shri. Hilter Sangma, members of the Village Executive Committee, land owners as well as other community members and stakeholders. More than 116 people from Umpher village attended the Public Hearing. The Public Hearing commenced with the reading of the Draft Social Impact Assessment report by the staff of MIG, Shillong.

Figure 20 Shri Hilter Sangma, Headman Umpher Village at Public Hearing on 30.01.17



Shri. Aiban Swer explained the need for Social Impact Assessment Study and said that the Public Hearing was conducted for further clarification on the said acquisition and for a joint review and discussion of the report. He also mentioned that Social Impact Assessment was a means to get the opinion of the people on whether the project will be beneficial or detrimental to them. He also clarified about the ownership of the land, that Shri Mac L.D, Shira had given the land to the Deputy Commissioner office to construct the Exit Point in Umpher village. He also mentioned that the issue of land ownership was settled during a Public Meeting held on 17th December 2016. There after the floor was opened for discussion on the proposed Exit point.

The following are the views of the participants on the proposed project:

Smt. Anita Lyngwa said that she has been living in the village for 31 years. She further said that the proposed project was a golden opportunity for her. However, the villagers are opposed to it as the land is small and it would affect the school, church nearby and hence the

Figure 21 Public Hearing 30.01.17





lives of the people residing in the village would be disturbed. So, she asked for any alternate site for this project.

Figure 22 Public Hearing 30.1.17



Shri. Joseph Warjri clarified that the village is not ignorant of the need for an Exit point, but the village is too small and it would affect everyone. He further said that they must think of their children's future. They won't be able to give land to their children and hence they asked for the site to be shifted.

Figure 23 Public Hearing 30.1.17



A school teacher also expressed his fears since the village is small and it would affect the St. Jude Secondary school and the Conservation Training Institute. This project would bring soil erosion, noise pollution and air pollution. The greenery and the healthy condition of the environment will also get affected. He requested the government to find a suitable place for this Exit point.

Brother Matthew, Principal, St. Jude Secondary School said that he represents the 600 student of St. Jude Secondary School and 55 hostel students and added that the proposed project will not affect the school but it will affect the student's life because the school is situated next to the highway and the students and teachers would be facing problems like

Figure 24 Public Hearing 30.1.17



noise pollution, air pollution and soil erosion. Therefore, he requested the Government to find a better place for construction of this Exit point.

Figure 25 Public Hearing 30.01.17



Father Remi (in-charge of Byrnihat Parish) said that the government needs to review the Social Impact assessment and the Land Acquisition. Taking 2acre of land would surely affect the village and the life of the people, he also mentioned that this Exit point was not good as it was close to the only main road of the village. On behalf of the Catholic Church, he requested the government to choose another site for this Exit point as it would destroy the village because too much land would be cut off.

Figure 26 Public Hearing 30.1.17



Shri. Remington Sangma said that he is from Umpher, Assam, but his family is in Umpher, Meghalaya. Students from Assam come to study in these two English Schools as there is no Medium English Schools there. This would affect the children of the village and no one wanted this Exit point.

Figure 27 Public Hearing 30.01.17



Shri. Marcus Momin who was the headman between the years 1995 to 2015 said that he had heard that in 2013 he had heard that the land had been bought in the presence of the Syiem. However, he was not present when the land was being surveyed. He concluded by saying that he does not want the Exit Point in his village as the land is too small.

Figure 28 Public Hearing 30.01.17



Anthony Sangma who is residing nearly 45 years in Umpher Village said that he did not know about the construction of Exit point in his village. He also mentioned that most of the people are against the construction of this Exit point and he also requested the government to find a suitable site for this Exit point.

Smt. Bernadette Rani who is an occupant of the land said that she had no knowledge that the land had been sold.



Figure 29 Public Hearing 30.01.17



Figure 30 Public Hearing 30.01.17

Shri. Mac Shira expressed that this project would bring development as well as employment opportunities to the people of the village. Allaying the fears of the people that the project would cause soil erosion, pollution of different kinds and other negative effects, he said that during the course of construction there would be professionals to oversee the construction and reduce the negative impacts that may arise from it. He also said that he had spoken to some engineers regarding these concerns and the engineers assured that no such problem would arise as safety measures would be undertaken. He also mentioned that to tackle issues like soil erosion, water logging structures like retaining wall, proper drainage system should be built.



Smt A. M. Marak said that is no problem with the Exit Point. However, there would be a loss of land to the village.

Shri. D.Arang the Nokma of Umpher in Assam said that the village is already a small one and the setting up of an Exit Point would further divide the village. He said that they are not a rich people and if the government is causing them problems then, they do not want the Entry – Exit Point.

The Public Hearing was concluded by a show of hands. Shri. A. Swer asked the people gathered to raise their hands if they were against or for the project. The majority of the people raised their hands.

## Addendum

---

On the 6th February, 2017 a representation of community members along with the land owners submitted a letter<sup>14</sup> in collective support and consent of Matchokgre village for setting up of Exit Point in 12<sup>th</sup> Mile, Byrnihat. In the letter submitted to the OSD, MIG it stated that the residents of Matchokgre<sup>15</sup> send their children to the same school in Umpher, and attend the same church as the residents of Umpher village. The letter also states that 60 per cent of the people who had attended the Public Hearing on the 30<sup>th</sup> January, 2017 were from Assam and that their leaders spoke against the setting up of the Exit Point at 12<sup>th</sup> Mile, Umpher, Byrnihat. The letter alleges that the meeting was “hijacked by these outside elements in collusion with a handful of prominent Umpher villagers” to protect their own interests. Continuing on the same lines, the Matchokgre residents allege that their Executive Committee members were heckled, stopped and threatened and not given a chance to speak in support of the Exit Point.

The letter speaks in support of setting up of the Exit Point which would bring development to the village. Lastly it contends that the attendance taken of the attendees of the Public Hearing on 30<sup>th</sup> January 2017 should be disregarded as it was procured through dubious means of coercion and threats prior to the Public Hearing. They allege that the attendance register received that day did not have their signatures.

Following this, on the 7<sup>th</sup> February 2017 a second representation<sup>16</sup> was sent by residents of Umpher village to the OSD, MIG. This second letter stated that a hostile environment was created by residents of Assam during the Public Hearing on 30<sup>th</sup> January, 2017 and due to this they had no choice but to remain silent to maintain a peaceful atmosphere. The letter states that the signatories have full faith that the Exit Point will bring about development which will outweigh any

---

<sup>14</sup> See Annexure 10

<sup>15</sup> Matchokgre, Umling Block, Ri Bhoi Dist. has one Lower Primary school.

<sup>16</sup> See Annexure 13

perceived notions of impairment in the village; nor will it harm their adjoining properties in anyway.

Both letters support the setting up of the Exit Point in Umpher, 12<sup>th</sup> Mile, Byrnihat and submit that the installation of the project will not bring any adverse effects to the residents of the area. The signatories were confident that proper scientific measures of construction would be used to ensure that there shall be no impediments to the movement of people in the village, the institutions present nor the people in the village.

## Summary of Findings

---

The following are a summary of the findings of the research team from their interaction with the village headman of Umpher, the owner of the land Shri. Mac Lyngdoh Shira, the residents of Umpher village and directly and indirectly affected families residing in and around the project site.

### 1. Ownership Issues

- a. The ownership of the land is complicated. Shri. Mac Lyngdoh Shira has documents showing that he had bought the land in 2013. However, during the interaction with the occupants of the land, Smt. Bernadette Rani claimed that land belongs to her and that the deeds to the land are with her brother Shri. Victor Rani. However, after a public meeting on 17<sup>th</sup> December 2016, the issue of land ownership had been settled and no disputes remain.
- b. Contrary, to the publics' contention that the setting up of the exit point at the village would mean a loss of land to the village's community, it is important to point out that the land itself is not community owned but is in fact private property and the loss of this land would mean loss of land to the directly affected parties, like the land owners and the occupants of the land

### 2. Location

- a. The Exit Point at Umpher is 4-5 kms away from the first entry point into Meghalaya from Assam at Khanapara.
- b. The distance between the Entry Point at 19<sup>th</sup> Mile and the Exit Point at 12<sup>th</sup> Mile is about 10 kms apart. The huge distance between these two points would make it a hindrance to the objective of checking on infiltration and influx.
- c. The site is on the NH-40 which is the border between these two states. The open border makes it such that the placement of the Entry and Exit Point should be strategic to avoid percolation.

### 3. Topography

- a. The area measuring about 2 acres is part of a hillock and the construction of the Exit Point would require considerable earthwork. This might disturb the surrounding land owners.
- b. The area is also longer than broad (See Map) and might not be suitable to the purpose of the project.

### 4. Livelihood.

- a. The respondents/directly affected persons are dependent on the land for their livelihoods as well as their place of residence.
- b. There would be loss of livelihood for the two families directly dependent on the land for their income.

### 5. Construction Phase

- a. The area is part of a hill and the setting up of an Exit Point necessitates that the hill be levelled. This would require massive earthwork. In the event that it is levelled, sites need to be identified for soil dumping.
- b. The cleanliness of the village needs to be maintained during construction phase as well.
- c. Most importantly, the cutting of the hill might impact the twelve households adjacent to the project site.

### 6. Road

- a. As the approach road to the village is close to the project site, entry to the village may be hindered.

### 7. Electricity Supply

- a. The electric pole situated on the project site would have to be removed and thus electricity supply to the adjoining villages would be disturbed.

### 8. Drainage

- a. The road floods often during the monsoon and spills over to the village. After construction of the project this could be avoided or reduced.

9. From the Public Hearing held on the 30<sup>th</sup> January, 2017 a majority of the participants were not in favour of setting up the Exit Point in the village as they were apprehensive of the amount of earthwork involved including the pollution to the village; loss in area of the village and the safety of the school children who attend St Jude's School and the Soil Conservation LP school both at Umpher.
10. However, from the two representations received by the OSD, MIG, certain new revelations/allegations arise that claim that there was coercion on the day of the Public Hearing and there was no freedom for the villagers to express themselves.



## Social Impact Mitigation Plan

---

As per The Right to Fair Compensation and Transparency in Land Acquisition, Rehabilitation and Resettlement Act, 2013 the Social Impact Assessment – Unit under Sub-section (6) of Section 4, is required to prepare a Social Impact Mitigation Plan. As such, the MIG may recommend the following.

1. Compensation along with solatium (Section 27-30) needs to be awarded to all families once title to land has been settled by the Office of the Deputy Commissioner (Revenue Branch). Steps must also be taken to ensure that damage is minimum to the twelve households living in and around the project site. And if it is not then a proper compensation for their loss must be made.
2. Resettlement of 2 families directly living in the project site must be awarded to these families. As per their wishes, these families have expressed resettlement under the same village, which is Umpher. Also, these families may also ask for awards such as residential houses under the Indira Awas Yojana under Schedule I and II of the Act. If there is extensive damage to the adjoining land the owners and tenants of the lands too need to be resettled.
3. For the family of Smt. Bernadette Rani who derives the majority of her income from the land, a proper economic alternative needs to be given to her so as to not cause the destitution of her and her household.
4. Under the Forest (Conservation) Act, 1980 Chapter 3 Section 3.1(i) compensatory afforestation must be made for the loss of all trees in the area.
5. Employment opportunities should be made and first preference given to suitable persons from the directly affected family. The second preference should be given to suitable residents of the village.

## References

- India, C. o. (2011). *District Census Handbook Ri Bhoi*. Retrieved february 4, 2017, from [http://www.censusindia.gov.in/2011census/dchb/1705\\_PART\\_B\\_DCHB\\_RIBHOI.pdf](http://www.censusindia.gov.in/2011census/dchb/1705_PART_B_DCHB_RIBHOI.pdf)
- Lyngdoh, R. (2014, April 30). Modified ILP Proposal in Meghalya. Calcutta. Retrieved October 2016, from The Telegraph: [https://www.telegraphindia.com/1140430/jsp/northeast/story\\_18292995.jsp#.WJRZzxt97IU](https://www.telegraphindia.com/1140430/jsp/northeast/story_18292995.jsp#.WJRZzxt97IU)
- Meghalaya Plans Entry/Exit Points to Check Illegal Immigration. (2014, July 10). Shillong. Retrieved from [http://www.business-standard.com/article/pti-stories/meghalaya-plans-entry-exit-points-to-check-illegal-immigration-114071001396\\_1.html](http://www.business-standard.com/article/pti-stories/meghalaya-plans-entry-exit-points-to-check-illegal-immigration-114071001396_1.html)
- Setting Up Of Entry/Exit Points To Check Influx Fast Tracked: Meghalaya CM Mukul Sangma. (2015, August 3). Shillong. Retrieved from The Economic Times: [http://articles.economictimes.indiatimes.com/2015-08-03/news/65165750\\_1\\_meghalaya-cm-mukul-sangma-draft-bill-meghalaya-regulation](http://articles.economictimes.indiatimes.com/2015-08-03/news/65165750_1_meghalaya-cm-mukul-sangma-draft-bill-meghalaya-regulation)

**Annexure 1 Letter From DC Office, Ri Bhoi District**

**GOVERNMENT OF MEGHALAYA  
REVENUE & DISASTER MANAGEMENT DEPARTMENT**

No.RDA.89/2015/21

Dated Shillong, the 5<sup>th</sup> February, 2016.

From: Shri. B.Hajong, MCS,  
Joint Secretary to the Govt. of Meghalaya,  
Revenue & Disaster Management Department.

To, The Deputy Commissioner,  
Ri-Bhoi District, Nongpoh.

Subject: **Acquisition of Land for construction of Integrated Facilitation  
Centres at 12<sup>th</sup> Mile, Byrnihat, Ri-Bhoi District.**

Sir,

I am directed to forward herewith the Notification Under Section 4(2) of the Right to Fair Compensation and Transparency in Land Acquisition Rehabilitation and Resettlement Act, 2013 bearing No.RDA.89/2015/22, dated 5<sup>th</sup> February, 2016 in both English & Khasi in respect of the above mentioned land for favour of publication both in English & Khasi Newspapers respectively in circulation in the locality without waiting for the publication in the Meghalaya Gazette.

In this connection, I am also to request you to keep a regular watch on the publication of the same promptly. The publisher may also be instructed to submit a copy of the newspaper clipping carrying the Notification to this Department.

Further, you are requested to kindly make necessary steps to display in the strategic location/affected areas as prescribed in the Act for wide publicity.

Yours faithfully,

Joint Secretary to the Govt. of Meghalaya,  
Revenue & Disaster Management Department.

**Memo. No.RDA.89/2015/21-A**

Dated Shillong, the 5<sup>th</sup> February, 2016.

Copy to :-

1. The Director, Printing & Stationery Department. A typescript copy of the Notification No.RDA. 89/2015/22, dated 5<sup>th</sup> February, 2016 is sent herewith for favour of publication in the extra ordinary issue of the Meghalaya Gazette and to supply 20 printed extra copies to this Department for necessary action and records.
2. The State Informatic Officer, NIC Shillong. A typescript copy of the Notification No.RDA. 89/2015/22, dated 5<sup>th</sup> February, 2016 is sent herewith with a request to kindly upload the said notification in this Department's Website [www.megrevenue.dm.gov.in](http://www.megrevenue.dm.gov.in) for information of all concerned.
3. The Secretary, Khasi Hills Autonomous District Council for information.
4. The Officer on Special Duty, MIG, Lumpyngngad Cottage, Bishop Cotton Road, Shillong-793001 with a request to carry out the SIA study within the stipulated time.

By order etc.,

Joint Secretary to the Govt. of Meghalaya,  
Revenue & Disaster Management Department.

CI/AK

**Annexure 2 Letter from Shri Mac Lyngdoh Shira**

ANNEXURE - "B"

(13)

To

Dated: 04.05.2015

The Deputy Commissioner  
Ri Bhoi District, Meghalaya.

**Sub: Availability of 15 Acres and 2 Acres of Land respectively for setting up of facilitation centers for Entry and Exit Points.**

Madam,

With reference to the subject cited above, I am happy that my land situated at 19<sup>th</sup> Mile Byrnihat (15 Acres) and 12<sup>th</sup> Mile Byrnihat (2 Acres), has been identified as the proposed Entry and Exit Points, for setting up facilitation centers.

In this connection and as requested by you I am submitting my land documents for verification and necessary action.

Thanking you.

Yours Sincerely



Shri. Mac Lyngdoh Shira



**Annexure 3 No Objection Certificate from KHADC**

c/b



**OFFICE OF THE EXECUTIVE COMMITTEE  
KHASHI HILLS AUTONOMOUS DISTRICT COUNCIL  
SHILLONG**

**NO.DC.RBF/XII/358/2015/5** **Dated: Shillong, the 3<sup>rd</sup> December, 2015.**

To,

The Deputy Commissioner,  
Ri-Bhoi District,  
Nongpoh.

Subject: - **Consent for initiation of land acquisition proceedings.**

Ref:- **Letter No.DCRB(CN) Border/6/2014/38, Dated Nongpoh, the 17<sup>th</sup> Nov.2015**

Sir,

With reference to your letter referred to above, I am directed to inform you that the Executive Committee, Khasi Hills Autonomous District Council hereby conveys its consent for the initiation of land acquisition proceedings in respect of Acquisition for **Setting up of Facilitation Centers at the Entry and Exit Point at 12<sup>th</sup> Mile and 19<sup>th</sup> Mile, Byrnihat, Ri-Bhoi District** falling within the territorial jurisdiction of the Khasi Hills Autonomous District Council.

This office maybe intimated on completion of the land acquisition proceedings or any dispute that may arise.

Yours faithfully,

  
**Joint Secretary to the Executive Committee,  
Khasi Hills Autonomous District Council  
Shillong**

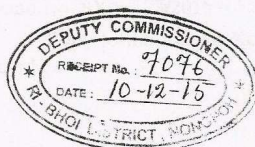

**Annexure 4 Public Notice for the Conduct of a Public Hearing on 30<sup>th</sup> January, 2017**



**Meghalaya Institute of Governance**  
Lumpynggad Cottage, Bishop Cotton Road  
Shillong- 793001, Meghalaya

**Phone No.:** 0364-2505977  
**No:** MIG 162/2016/543

**Email:** migshillong@gmail.com  
**Dated:** 16th January, 2017

**Public Notice**

The Meghalaya Institute of Governance has been notified as the State Social Impact Assessment (SIA) Unit to conduct Social Impact Assessment Study for acquisition of land measuring an area of 8268.12 Sq.mt at 12<sup>th</sup> Mile, Ri Bhoi District for the purpose of setting up proposed Facilitation Centre – Exit Point.

In connection with this, a Public Hearing will be held at Umpher Community Hall, Umpher, Ri Bhoi District at 11:00 a.m. on the 30<sup>th</sup> January, 2017.

All interested persons are invited to attend the said Public Hearing to express their claims/ objections/ suggestion, if any, on the proposal.

Dr. BDR Tiwari, IAS  
Executive Director,  
Meghalaya Institute of Governance,  
Shillong.



Annexure 5 Meeting on 25<sup>th</sup> August 2016

Project Name : Exit point  
 Village : 12 Miles  
 Date : 25.8.2016

Block: Umking

District: Ri-Bhoi

Sl. No	Name	Village	Contact No.	Signature/ Thumb Impression
1	C.P. Gotmare (Dc)			
2	Sanathan Shylla			
3	D.P. Khushabi			
4				
5	MAC LYNGA DOHSTRA			
6	A. SUPNGA			
7	Ricky Bantick Shakti (Mangrai)	Headman Bantick Shakti (Mangrai)	9859023625	Ricky Bantick Shakti
8	Anil Dolori	Secretary (Mangrai)	969864870	Anil Dolori
9				
10				

Annexure 6 Attendance During Focus Group Discussion on 15<sup>th</sup> September, 2016

Project Name: EXIT-POINT-  
Umpher  
~~AMPTHEA~~ - 12<sup>th</sup> MILE

Date: 15-09-2016.

Sl. No.	Name	Village	Contact No.	Signature
1.	Joseph Wangri	Umpher	8974344158	J. S. Wangri
2.	Philipson K. Sangma	Umpher	-	P.T.S
3.	Phinbat Marak	Umpher	8575704549	Phinbat
4.	Shri Marcus Momin	Umpher	9612269478	Shri Marcus
5.	Shertfeld Sangma	Umpher	8414079087	Shertfeld
6.	John D Sangma	Umpher	8414059204	John D.
7.	Aljiba G. Momin	Umpher 12 <sup>th</sup> mile	8414804883	Aljiba
8.	Rangin Marak	Umpher	8794058899	Rangin
9.	Rabit B Marak	Umpher	8974238093	Rabit
10.	Hiltu G. Sangma	Umpher	9856391287	Hiltu (Headman)
11.	Agnesth Momin	Umpher	986295220	Agnesth
12.	Rucena G. Momin	Umpher	9862855167	Rucena
13.	Arailin B. Marak	Umpher	9815127682	Arailin
14.	Anita Lyngwa	Umpher	8257963213	Anita
15.	Salsaina Marak	Umpher	-	Salsaina
16.	Foendimth Marak	Umpher	9862313388	Foendimth

Meghalaya Institute of Governance - SIA Unit



Public Consultation and Disclosure on the setting up of  
Facilitation centre- Exit point at 12<sup>th</sup> Mile, Byrnihat

Place: 12<sup>th</sup> Mile, Umpher Bhoi  
Date: 17-Dec-2016

Sl.no	Name	Gender (M/F)	Designation/ occupation	Contact No	Signature
1	HILTER SANGMA	M	HEADMAN	986379856391287	
2	Abir Ma	M	Labour	8014336619	
3	Pradict Son Marak	M	Shop	9862476337	
4	Tennie B. Marak	M	Factory	8575635677	
5	Bijoy Morrin	M	Business	8974641271	
6	Bibul Sangma	M	Rel. CTI Sult Chokidar	-	
7	Shorjeeid Sangma	M	Business	8414079087	
8	Son Moni Kakheli	M	Driver	97877779771272605	
9	Betil G. Monin	M	Teacher	8729847635	
10	Nan Singh G. Momin	M	Labour	8974374080	
11	Aras Benth. Marak	M	Labour	8974319001	
12	Baitarson Marak	M	Student	8575421362	
13	Phingseng Akhy Sangma	M	Student	9774805037	
14	Chitra Marak	M	Student	9774852516	
15	Ashish Demta	M	Student	8578979766	

Public Consultation and Disclosure on the setting up of  
Facilitation centre- Exit point at 12<sup>th</sup> Mile, Byrnihat

Place: Wanphar Village

Date: 17-12-16

Sl.no	Name	Gender (M/F)	Designation/ occupation	Contact No	Signature
16	Khagen Kabla	M	Driver	9693699541	<i>[Signature]</i>
17	Morris Masing	M	Leaver	8974207653	<i>[Signature]</i>
18	Salsang Marak	M	-	8258028302	<i>[Signature]</i>
19	Frederick Marak	M	BSNL Security	9862313288	<i>[Signature]</i>
20	Khipenath Marak	M	Vill. member.	9127089635	<i>[Signature]</i>
21	Shin Marcus G. Monih	M	Ex. Headman.	9612269478.	<i>[Signature]</i>
22	Bitchor Marak	M	P.H.E Master Roll.	9862317339	<i>[Signature]</i>
23	Li. Chetki	M	WV chetty	9862210345	<i>[Signature]</i>
24	Mr. Francis K Saru	M	<del>Teacher</del>	9863761446	<i>[Signature]</i>
25	Mr. Sotendro Madan	M	Teacher	8976138667	<i>[Signature]</i>
26	Shin Challeng Monia	M	Member.	8014285512	<i>[Signature]</i>
27	Bupad Sarapin	M	<del>R.H. Soil. C.F.I.</del>		<i>[Signature]</i>
28	Rohit Marak	M	Farmer	8974238093	<i>[Signature]</i>
29	A. Borogor	M		977456145	<i>[Signature]</i>
30	Victor Ramee	M	MDC- Jwing	9862476015	<i>[Signature]</i>



**Public Consultation and Disclosure on the setting up of  
Facilitation centre- Exit point at 12<sup>th</sup> Mile, Byrnhat**

Place: *Uaphu Village*

Date: *17.12.10*

Sl.no	Name	Gender (M/F)	Designation/ occupation	Contact No	Signature
31.	Mac LYNDON SHARA	M	<i>Land Owner</i>	7085059027	<i>[Signature]</i>
32.	ANDREW SUTIN SA	M.		8974374080	<i>[Signature]</i>
33.	Khela Bangma	F	House wife	9615914882	<i>[Signature]</i>
34.	Pabbis Manu		Business	9615127682	<i>[Signature]</i>
35.	Ardilin B. Marak		Business		<i>[Signature]</i>
36.	Queen G. Manu		Business -		<i>[Signature]</i>
37.	Agomph M. Marak				<i>[Signature]</i>
38.	Makelalin Manu				<i>[Signature]</i>
39.	Shila Manu	F			<i>[Signature]</i>
40.	Nimale G. Manu	F			<i>[Signature]</i>
41.	Resinani Manak				<i>[Signature]</i>
42.	Ardilin Manu	F			<i>[Signature]</i>
43.					
44.	Sonathan Snylla	M	E.A.C. - Ri Bhai		<i>[Signature]</i>

**Public Consultation and Disclosure on the setting up of  
Facilitation centre- Exit point at 12<sup>th</sup> Mile, Byrnihat**

Place: *Lempher Village,*

Date: *17<sup>th</sup> 12. 16*

Sl.no	Name	Gender (M/F)	Designation/ occupation	Contact No	Signature
45	<i>Aljiba G. Manin</i>	F	<i>House. Wife</i>	<i>8414807883</i>	<i>[Signature]</i>
46	<i>Alucilia G. Monin</i>	F	<i>House. wife</i>	<i>9856066581</i>	<i>[Signature]</i>
47	<i>Sardish. M-Sangma</i>	F	<i>House. Wife</i>	—	<i>S. Sangma</i>
48	<i>Poarkin P. Sangma</i>	F	<i>House. Wife</i>	—	<i>P. Sangma</i>
49	<i>Healin S Monik</i>	F	<i>Business. Shop</i>	<i>9862076974</i>	<i>[Signature]</i>



Annexure 8 Attendance at Public Hearing held on 30<sup>th</sup> January, 2017

*dated 30.01.2017*

Public Hearing (Exit Point gate) meeting attendance. Page 1

Names	Designation	Phone no.	Sign
1.			
2. Shri Joachim Kanakulak			<i>[Signature]</i>
3. Willu Sangma	(Headman)		
4. Shri Marcus G. Momin	Ex-Headman	9612269478	<i>[Signature]</i>
5. " Rabih B Marak	Secretary member	8974238693	<i>[Signature]</i>
6. " Sheffield Sangma	member	8414079087	<i>[Signature]</i>
7. " Lil B. Chetki	member	9862210345	<i>[Signature]</i>
8. " Hubert T. Sangma	Secretary	9856154194	<i>[Signature]</i>
9. Dikshit Arungh Govt Gombak		98561-78312	<i>[Signature]</i>
10.			
11. " Alberus Lepung	"	977409744	<i>[Signature]</i>
12. " Fr. Renny V.P.	Parish Priest, Bpm	09436107834	<i>[Signature]</i>
13. " Bro. Mathew Nyondimachal	CP	8119862240	<i>[Signature]</i>
14. " Ardilin Marak	MSongri member	9615127682	
15. " Notileh	Marak Songri member		
16. " Agnes Momin	Songri member		
17. " Queen G. Momin			
18. " Happybal Marak			
19. " Anima Marak		ph-8731903379	
20. " Lesisha Marak		Ph 9085050	
21. " Fungilis Sangma			
22. " Phodilla Marak			<i>[Signature]</i>
23. " Barnadish Momin			
24. " Norgini Momin		ph 8731903345	
25. " Endlish Marak			
26. " Shila Momin		8415990417	
27. " Mondish Sangma		8575346376	
28. " Stella Marak			
29. " Rupalia M. Marak			<i>[Signature]</i>
30. " Menilla Marak			
31. " Buktul B. Marak		8575421362	<i>[Signature]</i>
32. " Loke Momin		9615914882	<i>[Signature]</i>
33. " Prendinath Marak			<i>[Signature]</i>
34. " Lakshirth Marak			<i>[Signature]</i>
35. " Bitchon Marak			<i>[Signature]</i>
36. " Khinbent. Marak			<i>[Signature]</i>



- 38) Lidina Momin Ambher.
- 39) Genalish Sangma. Ambher.
- 40) Rikboni Momin, Malchete.
- 41) Rebeka Marak Ambher
- 42) Ulsa Marak Ambher
- 15 Kholo Marak  
D. Sangma Momin
- 16 Lidina Sangma
- 17 Panida Marak
- 18 Benanika Marak
- 19 Bone Rapa
- 20 Kupali Rapa
- 21 Julie Marak
- 22 Borita Marak
- 23 Dola Marak
- 24 Mezi Marak
- 25 Angulie Marak
- 26 - Ketarish - Sangma. Ambher.
- 27. Sint. Rezyia Marak - Ambher - Ambher, Momin.
- 28 Rezyia Marak M
- 29 - Nisha D. Marak
- 30 - Andei Lyngda
- 31 - Putol Rani
- 32 - Nirojini Marak
- 33 - Radish Sangma.
- 34 - Tesesa. Marak.
- 35 - Rina. Marak.
- 36 - Poni Marak.
- 37 - Memunides Jui
- 38 - Naruta D. Sangma
- 39 - Lalita. G. Momin
- 40 - Carmela N. Marak
- 41 - Mitali Sangma
- 2. Mira R. Marak
- Mehalin R. Marak
- Deba Sangma



- 45 Prasidha Marak
- 46, Kubali D. Sangma,
- 47 Tara Busuwa Sharna,
- 48, Tamuna Sharna.
- 49, Celilia H. Monin
- 50, Ekilda, Sangma,
- 51/ Anjeli G. Monin
- 52/ Lalnemruati
- 53. Kapsai Sangma. (Secretary Sangma) 8794336093 Sgn.
- 54. CEPSTAR MARAK Rangakona 7308 390036 CCR
- 55, Shi S.O. MARAK. Amphenggi
- 56 Ript Sangma
- 57, Bedikson Sangma
- 58 ~~ANTON HZI~~
- 59 Raju Biswabarna
- 60/ Kripomath Marak
- 61 - Rajesh Samra
- 71 Tingliansiak
- 62. Hemush ar Marak
- 63. Nimal - Raj -
- 64 Jepson Sangma
- 65 Turan Mo
- 66. Jhan Chiang.
- 67 S. Uta
- 68 Bogatom. Monin
- 69 Sornoni karoti
- 70 Gadeb
- 71 Bimoy
- 72/ Bojin Sangma,
- 731 Belik Sam. Monin
- (74) Herdand. Sangma
- 75 Sali Marak
- 77 Pilot. S. Sangma
- Pi. Sangma
- Praxis Sangma

*[Handwritten signature]*  
*[Handwritten signature]*  
*[Handwritten signature]*

Amboher *[Handwritten signature]*



28	Symod Ryan Richards	Amthor	
9	Mazpoda Momin	Amphor	M. B. J.
0	Sijon Sijon		
Kororarak Marak			
	Coronel. of Sangma		
1	Khagen Kalita		K. Kalita
4	Pintue Hardnabag		P. Hardnabag
5	Botkong Marak		B. Marak
36	Wilba Sangma		W. Sangma
37	Silber's Han		S. Han
88	Alfons N. Akerf		A. Akerf
91	Larsen Marak		L. Marak
20	Tenny Marak		T. Marak
91	L. Marak		L. Marak
92	Dilip Lama		D. Lama
93	Toran Marak		T. Marak
94	Kennedy "		K. "
95	Toku D Sangma		T. Sangma
96	Bene Dees		B. Dees
97	Kiron Kalita		K. Kalita
98	Juha Dees		J. Dees
99	Arne Marak		A. Marak
100	Rose Marak		R. Marak
101	Pranilla Sangma		P. Sangma
102	Rudinto Saps		R. Saps
103	Peki Brah		P. Brah
104	Tuntus Momin		T. Momin
105	Sanka Poro		S. Poro
106	Selindra Marak		S. Marak
107	Saltain Marak		S. Marak
108	Phomkong Minky		P. Minky
109	Sijon Sangma		S. Sangma
110	Erwin Momin		E. Momin
111	Gagar Chiki		G. Chiki
	W.R.D.		

Anjek



113/ Rajen Lavee  
114/ Yamini G Menin  
115/ Surri G Menin  
116/ Kennedy Marak  
117/ Arun Chandhug  
118/ Bob  
119/ Babu

Page 5  
Dr.  
Gopin  
Ganani.  
A. W. J.  
Babu

CITY/REGION

SHILLONG ■ SATURDAY ■ JANUARY 28

# Garro NGOs seek shifting of 'exit point'

**GUARDIAN NEWS BUREAU**  
TURA, JAN 27: Various NGOs of Garo Hills region have demanded shifting of an infiltration check gate coming up at Umpher in Ri-Bhoi district.

A delegation of the NGOs -- GHSMC, AYC and AAYF -- submitted a memorandum in this regard to the chief minister Mukul Sangma his official residence recently.

The NGOs demanded for shifting of the "exit point" from 12th Mile, Umpher to another location.

"While we appreciate the setting up of an Integrated Facilitation Centre in lieu of an Inner Line Permit (ILP) to check for unwanted presence in the state as well as stop illegal immigration, the proposed entry (19th Mile, Pahammawlein) and exit point at 12 Mile Umpher is almost 10 kms apart," said Nikman Ch Marak, the chairman of the GHSMC.

The NGOs objected to the site of the exit point being set up at Umpher.

"The proposed site for setting up the exit point is located on a hilly terrain mostly inhabited by Garo community who have been residing permanently therein since time immemorial. Most of its populace is illiterate, economically and socially backward and very poor," said Dardy G Ch Marak.

Interestingly, the proposed site measuring 2.0431 acres is a narrow patch located along St. Jude's Secondary School, Umpher, Conservation Training Institute, Byrnihat, a village road and house of a private individual.

"The proposed land is a stiff hillock of around 30-35 metres in height. If the earth is cut to the level of NH-40, the houses of the Garo community and others on top of the hillock would be at serious risk of collapsing in case of landslide. They will become homeless in their own land," said Sarav Marak, the general secretary of AAYF.

The NGO asserted that about 6 villages would be affected by the construction of the exit point.

"There is no other alternative road for them and it would definitely affect the livelihood as they would find it very difficult to sell their perishable goods.

The NGOs also pointed to the loss of livelihood that has been brought about by the setting up of a four-lane highway. The NGO in their memo as well as in the meeting urged the chief minister to seek a different location so as to ensure the villagers are not affected due to the proposed check gate.

The NGOs also suggested the use of the same site at 19th Mile for both the entry and exit check points.

"It would be disastrous to the general people of the areas and as such our request," the NGOs added in their memo.

BSF D  
Pr  
po  
GUAR  
SHILLC  
Josep  
Genera  
halaya  
with t  
medal

Da  
e  
o  
h  
T  
E  
;

(Source: The Guardian Newspaper, Shillong, Jan 28, 2017)



**Annexure 10 Letter From Matchokgre Village Durbar in Support of Setting up Exit Point at 12<sup>th</sup>**

**MATCHOKGRE VILLAGE DORBAR**  
**RI-BHOI DISTRICT, MEGHALAYA**

Ref. No. ....

Date 06/02/17

To  
The Director (SIA)  
Meghalaya Institute of Governance  
Shillong.

**Subject:- Collective Support and Consent of Matchokgre Village for setting up of Exit point, 12 Mile Byrnihut.**

Sir,

With reference to the subject mentioned above, we the Executive Committee, Dorbar Shnong of Matchokgre Village, 12th Mile Byrnihut, would like to inform you, that we are deeply saddened at the way, events unfolded on the 30 January 2017, at St Jude school field, during the SIA meeting conducted by your esteemed department.

Right from the outset, we wish to draw your kind attention and stress on the fact, that the residents of Matchokgre village, send our children to the same St Jude School, attend the same Church, use the same village road and other surrounding as Umpher Villagers. Hence, we have intimate knowledge of the areas, surrounding the proposed site. Further, any kind of benefit or effect, that will percolate from setting up the facilitation centre, will be the same for both the villages.

Considering this fact, we wish to let you know that on the fateful day, Sixty percent (60%) of those who attended the meeting where from Assam, including a large number of women and youths. As can clearly be seen in the video footage of your esteemed department, some of their leaders also spoke on the occasion, against the setting up of the Exit point.

We wish to strongly emphasise, that the meeting was hijacked by these outside elements in collusion with a handful of prominent Umpher villagers, who are against setting up of a facilitation centre there, for reasons best known to them.

On that day, and in a premeditated move, our Executive Committee members were also heckled, stopped and threatened by these same people and were never afforded a proper opportunity to speak in support of setting up the Facilitation centre.

We are therefore, writing this official letter to register our complain and to express our strong support for setting up the Exit point in the proposed site. We are strongly motivated to do so since, being poor villagers, we wish to see development in our area, and that our children are given the opportunity for growth, which will surely arise, with the setting up of any government institution here.

Additionally, we also urge you to disregard the attendance register of that day, as submitted by the opposing group as it is a fabricated one and one that was procured through dubious means of coercion and threats against innocent villagers, days prior to the SIA meeting.

To substantiate our allegation, we will only point to the fact that our names and signatures are missing from the register, while we were very much present there, as pictures and video footage, bear witness to the same. The names of other supporters and previous land owners of the proposed site, are also missing from the same.

Lastly, the often, repeated grounds of opposition, that Umpher Village will lose its land if the facilitation centre is set up, does not hold any water. Since, the proposed site is not Community/Village land, but private land and has been offered to the government willingly, freely and without any duress.

And as far as the contention that it will affect St Jude School, Conservation Training Institute, the Church and the Village road, it is our humble opinion that these are just pretexts, to mislead innocent villagers, whereas the real intent is to protect the illegal businesses set up in the village road itself, by those leading the opposition (including their relatives, friends and associates) against the Exit Point.

With all this in mind, we urge you to do the needful and consider our point of view and wholehearted support for the proposed project, as we were regretfully unable to express the same during the SIA meeting on the 30<sup>th</sup> January 2017.

Thanking you

Yours Sincerely

  
Mathiabi Sg.  
ASS.T. SECRETARY

  
Francis Sangma  
(Executive member)

  
Headman  
Matchokgre Village  
Raid Marwet, Ri-Bhoi Dist.  
Meghalaya  
A U S  
Aamin Sangma  
(Executive Member)



**Annexure 11 Land Deed of Shri Victor Rani**

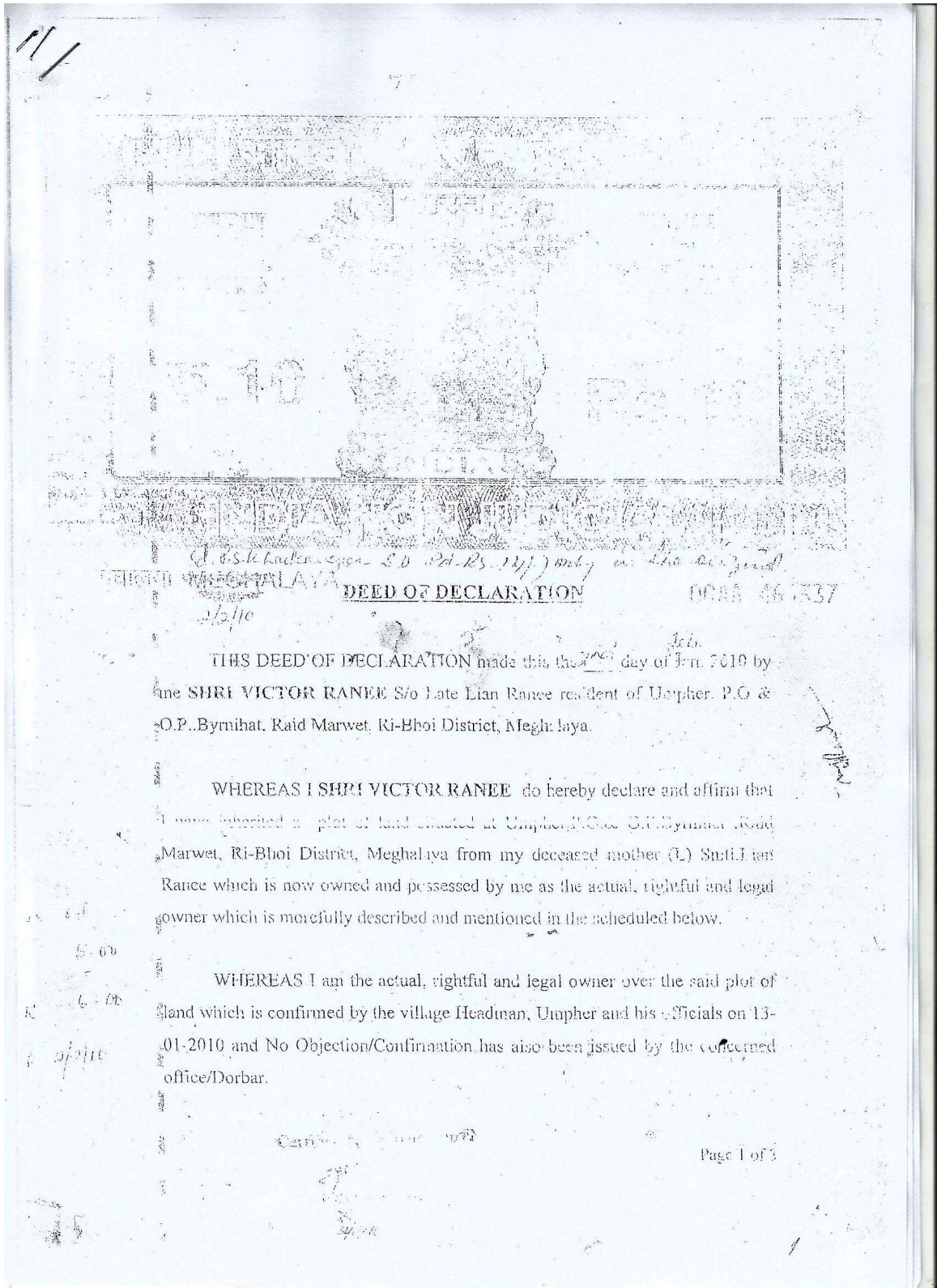





मेघालय MEGHALAYA

00AA 097632

WHEREAS the confirmation document issued by the Headman and as the actual, legal and rightful owner having rights, title, interest and possession thereon will form a part of this DEED OF DECLARATION.

That the attested photocopy of all the said documents are enclosed herewith for recording the same in the office of the Sub-Registrar, Ri-Bhoi District, Nongpoh for future reference.

That this is further to declare that the instrument of confirmation of said land was previously registered in my mother's name (L) Lian Ranev wife Deed Of Declaration dt.05-02-1992 in the office of the Sub-Registrar, Ri-Bhoi District, Nongpoh and I hereby made this DEED OF DECLARATION in order to make the same registered in the same office.

SCHEDULE OF THE LAND

East	: Guwahati Shillong Road	57.00 metres
West	: Land of Ka Lin Synrem	105.30 metr.
North	: Land of U Rojen Sangma	43.80(+3mt)36mtrs
South	: Land of Sinti.Mildred Warjri	100.00 metr.
Total Area of Land = 7563.00 sq.metr. (more or less)		

Certified to be true copy.

Page 2 of 3

*[Signature]*  
Sub-Registrar,  
Nongpoh, M.  
2/2/10





मेघालया MEGHALAYA

00AA 097621

THAT the entire area of the said land as mentioned in the scheduled above is fully possessed by me as the actual and legal owner without any interference.

IN WITNESS WHEREOF, I put my hands and seal the day, month and year first above mentioned in the presence of witnesses at Nongpoh, Ri-Bhoi District, Meghalaya

WITNESSES

1. *Winston Singh* (Signature)

*(Signature)*

(VICTOR RANEE)

DECLARANT

2. *Sri. Medhi Syiam* (Signature)

Certified to be true copy.

Page 3 of 3

*(Signature)*  
Sub Registrar,  
Nongpoh,  
2/2/16

**Annexure 12 No-Objection Certificate from Umpher Village to Shri. Victor Ranee**

**UMPHER VILLAGE DUKBAR**  
12TH MILE, BYRNIHAT RI-BHOI DIST. MEGHALAYA-793101  
Ph: 9862317388 / 9863066558

Ref.No:..... Date: 13/01/2010

TO WHOM CONCERN.  
CUM  
NO OBJECTION CERTIFICATE.

This is to certify Smt. Lian Ranee of village Umpher (12<sup>th</sup> mile) P.O. Umpher - 793101, Byrenihat O.P., P.S. Nongpok, Ri-Bhoi Dist., Meghalaya had expired on the 9<sup>th</sup> DEC. 2009 at 5:45 A.M. at her residential house after a long illness.

She have a plot of land at 12<sup>th</sup> mi which boundaries schedule as follows.

East: Lsauhate Shillong Road. 57.00 m.  
West: Land of Ka Lin Synkem. 105.30 m.  
North: Land of U Rojen Sangma 43.80 (437.36.00)  
South: Land of Smt. Mildred Waijri 100.00 m.

Total area 7563.00 Sq.m. more or less

The village Dukbar have no objection of this land being transferred to her elder son Shri Victor Ranee.

Shri Marcus Mo  
M. 9612646257.  
P. 9612414013.  
Headman,  
Vill - Umpher  
Ri-Bhoi Dist-Meghalaya

Certified to be true COPY  
2/2/10



## Annexure 13 Letter in Support of Proposed Exit Point at 12<sup>th</sup> Mile

To  
The Director  
Meghalaya Institute of Governance  
Shillong

**Subject: Support for setting up Facilitation Centre at Umpher Village, 12<sup>th</sup> Mile Byrnhut.**

Respected Sir,

We the undersigned former Land Owners, residents of Umpher Village and Supporters in favour of setting up a facilitation centre Exit Point, humbly submit this representation to let our views known to your esteemed department.

Most of us, keeping in mind the hostile environment created by residents of Assam and certain Umpher Villagers, during the SIA meeting conducted on the 30<sup>th</sup> January 2017, had no choice but to remain silent on the issue of setting up the Exit Point during the meeting, to maintain a peaceful atmosphere and in the interest of preserving our own personal integrity and dignity, during the public hearing.

We the undersigned are also people and have families, who live right next to the proposed site and will be directly affected should the government undertake to develop the site.

However, we have been properly informed about the intentions of the government, and have full faith that it will not act to harm our interest or our adjoining properties in anyway. And, we are certain that the benefits including development of the area and job opportunities to residents here, will outweigh any perceived or misconceived notions of damage or impairment, held by certain residents here.

Also, we have seen that extensive excavation had taken place while setting up the petrol pump and an Industry in the same hillock, that some of us reside in. And although, no retaining wall has been constructed by the owners of the petrol pump or the industry, the hillock has remained the same.

We are sure that the government will take precautionary measures to check soil erosion etc. that some people who are opposed to the proposed project have raised.

We also collective state that people of the area who are largely illiterate and economically backward, have been misled and misinformed, by certain people who wish to protect their own personal vested interest. We are sure you have been informed of the prevailing ground situation, so we will refrain from delving into the same.

We also fully endorse the point of view that was recently reported in a section of the print media that "The proposed site is on a private land and does not affect the Village road. It is also far away from St' Jude's Secondary School and the Conservation Training Institute, Byrnhut. In fact, these have nothing to do with the proposed site, either in relation to their proximity or any other alleged impact".

In conclusion, we would like to thank you for allowing us to submit our representation thereby, empowering us to give our positive feedback to your esteemed department.

Thanking you

Sincerely yours



We the Undersigned: -

Shri. Victor Ramesh M. D. C.

Sabha-R. Marak

Rasida G. Momin

Jengbon Ch. Sangma

Matdalin Momin

Nimamala M. G. M

Deravinson Morak

Borajatha Momin

Sujatha Momin

Vijay Das

Nikchima Momin

Nandony Momin

Baloika Saipaa

Challang G. Momin

Sardis M. Sangma

Belds G. Momin

Donolis J. Sangma

Tanghina T. Sangma

Arzun Ch. Morak

Shri. Victor Ramesh  
Member of Khasi Hills Autonomous  
District Council  
Jirang Constituency

R. G. Momin

J. Ch. Sangma

M. G. Momin

W. Momin

2/2/2017

C. Momin

3/2/17



We the Undersigned: -

Sebastin D. Sangma

Pelkig - Marak

Beril G. Momin

Ajay A - Momin

Samuel Rani

Blistina Passak

Brightlinda G. Momin

Minderson R. Marak

Danang G. Momin

Mae Lyngdok Shira

Vincent Lyngwah Raptap

Andrew T. Sangma

Daud T. Sangma

LUCKCHIANA G. Momin

Edward G. Momin

Sandikena B. Marak.

HeMusesk R. Marak.

Ravi Wilson D.

Mimig Momin

Keston R. Marak

Fridena R. Marak

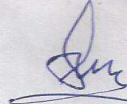

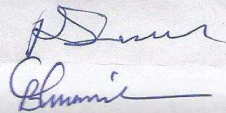

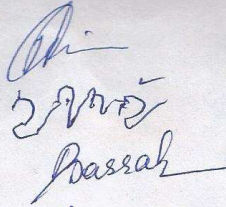



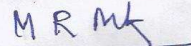

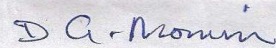

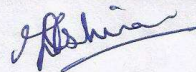

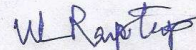







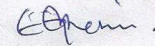



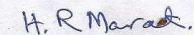

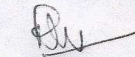

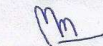







Wan Beng & Momi	Dymen
Ikki Uda M Sangma	ES Sangma
Francis Sangma	Rogue
Ritha Ch. Marak	Ruk
Jamestari G. Momin.	Jamata
Francis Marak	Marak
Anaida G. Momin	Momin.
D. D. Barman	<del>S</del> CSangma
Gruke. Chegen M. Sangma	
Dechang M Sangma	<del>A</del>
Jenastin Momin.	JMomin.
Hemington. Marak.	HMarak
ALGIBA G. MOMIN	<del>A</del>
Merina Atengh	M. Atengh
Lendina B. Sangma	<del>LSangma</del>
Septali Sangma	<del>S</del>
NIRANI SANGMA	<del>N</del>
Helina A. Sangma	<del>H</del>
Sobita D. Sangma	<del>S</del>
Ramalin Momin	R.M
MAMONI K. SANGMA	MAmomi



Muthuni Ch. Marak.

Deda Sangma

Sunjittha K Sangma

Nirani Sangma

Asha Marak

Sunome Sangma

Goatila Marak.

Telming Marak

Will Bat Momin

NURULSON K SANGMA

Robin Sangma

Ashish Marak

Kumar

D. Sangma

~~S~~

~~B~~

~~A~~

S Sangma

~~S~~

~~T~~

~~W~~

N. ISS

~~D~~

~~Amarak~~